

Propriétaire



Confidentialité et politiques

Ce document est la propriété ZAXE TECHNOLOGIES et ne peut être utilisé pour d'autres fins que celles pour lesquelles il a été préparé et soumis. Aucune reproduction ne peut être faite sans autorisation.

The information contained in this drawing is the sole property of zaxe technologies. Any reproduction in part or as a whole without the written permission is prohibited.

©2019 Tous les droits réservés /All rights reserved.

No. de produit / Product Part Number:

450-00080

Designation du produit / Product Name

FEED WEIGHER

Titre du dessin / Drawing Title

INSTALLATION GUIDE

Révision / Revision Feuille / Sheet:

A 1 / 10

Matériau / Material specifications:

N/A

Unités / Units:

mm[in]

Standard Tolerances:

Inches

X/X ± 1/16"
X.XX" ± 0.03"
X.XXX" ± 0.010"

Millimeters

X.X ± 0.8
X.XX ± 0.25

Angle

X.X° ± 0.5°

Dernière mise à jour / Last update date:

2021-01-20

Dessiné par / Drawn by:

LJ

Approuvé par / Approved by:

Historique de révision / Revision history:

REV.	DESCRIPTION
00	INITIAL RELEASE
A	- WEIGHING AND RECEIVING BIN HEIGHT WERE RESPECTIVELY 1760mm(69in) AND 586mm(23in) - ANTI-OVERFLOW KIT ADDED

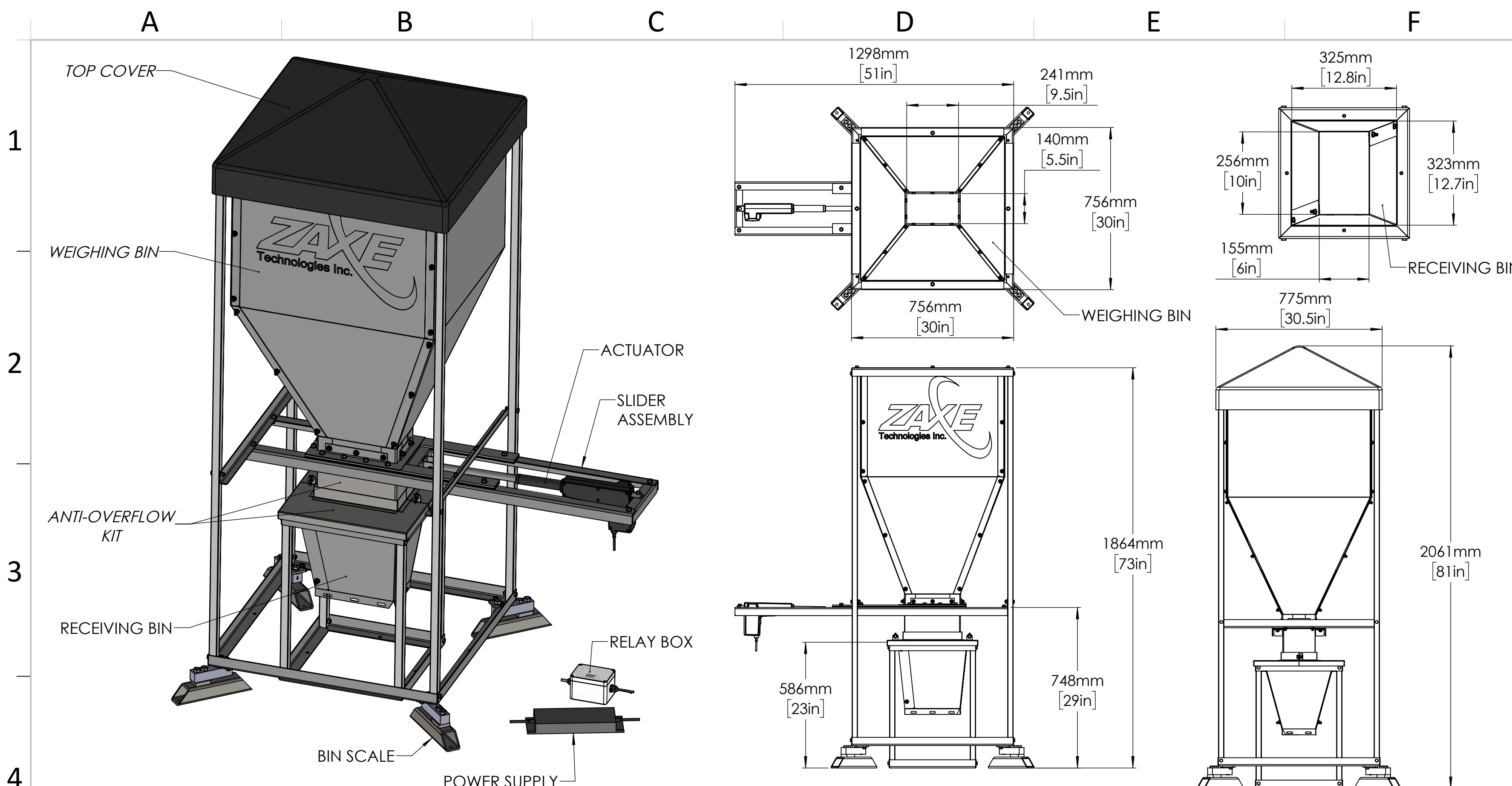

PART LIST (FOR FINAL ASSEMBLY, IF THE PRODUCT IS SHIPPED PRE-ASSEMBLED)

<p>(1X) WEIGHING BIN ASSEMBLY 450-00080R</p>	<p>(1X) TOP COVER 450-00080T</p>	<p>(4X) BIN SCALE, 250 lb 310-00021</p>	<p>(1X) POWER SUPPLY 24V 103-00061</p>	<p>(1X) RELAY BOX 012-00023</p>	
	<p>(1X) ANTI-OVERFLOW KIT 450-00080A</p>	<p>(1X) ACTUATOR 100-00025</p>	<p>(1X) HEX BOLT, 2" 011-00062</p>	<p>(1X) HEX BOLT, 1 1/2" 011-00067</p>	<p>(12X) SERRATED FLANGED HEX BOLT, 1" - 011-00060</p>
	<p>(1X) RECEIVING BIN ASSY 450-00080B</p>	<p>(1X) SLIDE GATE ASSEMBLY 450-00080S</p>	<p>(10X) SERRATED FLANGED HEX BOLT, 3/4" - 011-00058</p>	<p>(22X) SERRATED FLANGED HEX NUT - 011-00059</p>	<p>(2X) LOCKNUT 011-00020</p>
				<p>(2X) WING NUT 011-00110</p>	

IMPORTANT NOTES

- BEFORE BEGINNING THE ASSEMBLY, ENSURE YOU HAVE THE RIGHT TOOLS READY : ONE 1/2" FLAT WRENCH AND ONE RATCHETING SOCKET WRENCH WITH A 1/2" SOCKET .
- ALL THE BOLTS AND NUTS PROVIDED ARE MADE FROM STAINLESS STEEL. TO PREVENT GALLING AND REDUCE THE CHANCE OF PREMATURE FAILURE, THEY MUST BE LUBRICATED. NICKEL-BASED ANTI-SEIZE LUBRICANT SUCH AS LOCTITE NICKEL ANTI-SEIZE OR PERMATAX NICKEL ANTISEIZE LUBRICANT ARE RECOMMENDED. IF NOT AVAILAIBLE, PENETRATING OILS SUCH AS LIQUID WRENCH OR WD-40 CAN ALSO BE USED.
- IT IS STRONGLY ADVISED NOT TO FULLY TIGHTEN THE BOLTS AS INDICATED FOR MOST OF THE ASSEMBLY STEPS BECAUSE IT MIGHT BE CONVENIENT FOR THE SUBSEQUENT STEPS TO BE ABLE TO SLIGHTLY ADJUST THE PARTS. ONLY ENGAGE EACH NUT WITH HAND UNTIL IT PASSES THE BOLT TIP. AN INSTRUCTION WILL BE GIVEN WHEN IT WILL BE APPROPRIATE TO FULLY TIGHTEN THOSE BOLTS.
- REFER TO DRAWING **012-00023** FOR THE RELAY BOX WIRING DIAGRAM.
- REFER TO DRAWING **310-00021** FOR DETAILED INSTRUCTIONS FOR BIN SCALES ASSEMBLY.



Confidentialité et politiques
Ce document est la propriété ZAXE TECHNOLOGIES et ne peut être utilisé pour d'autres fins que celles pour lesquelles il a été préparé et soumis. Aucune reproduction ne peut être faite sans autorisation.

The information contained in this drawing is the sole property of zaxe technologies. Any reproduction in part or as a whole without the written permission is prohibited.

©2019 Tous les droits réservés /All rights reserved.

No. de produit / Product Part Number:

450-00080

Designation du produit / Product Name

FEED WEIGHER

Titre du dessin / Drawing Title

INSTALLATION GUIDE

Révision / Revision Feuille / Sheet:

A 2 / 10

Matériau / Material specifications:

N/A

Unités / Units:

mm[in]

Standard Tolerances:

Inches

X/X ± 1/16"
X.XX" ±0.03"
X.XXX" ±0.010"

Millimeters

X.X ± 0.8
X.XX ±0.25

Angle

X.X° ± 0.5°

Dernière mise à jour / Last update date:

2021-01-20

Dessiné par / Drawn by:

U

Approuvé par /Approved by:

INSTALLATION PROCEDURE

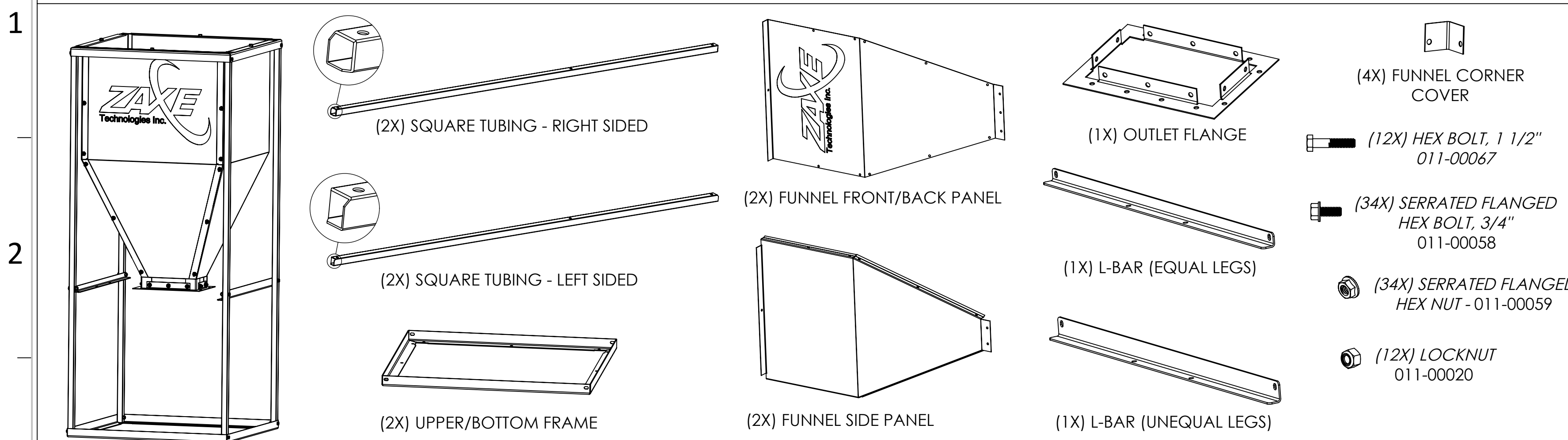

STEP 1: WEIGHING BIN ASSEMBLY. ENSURE THAT ALL THE PARTS LISTED ABOVE ARE AVAILABLE BEFORE BEGINING THE ASSEMBLY. **SKIP THIS STEP AND THE SUBSEQUENT STEPS IF THE WEIGHING BIN IS SUPPLIED PRE-ASSEMBLED, GO TO STEP 24.**

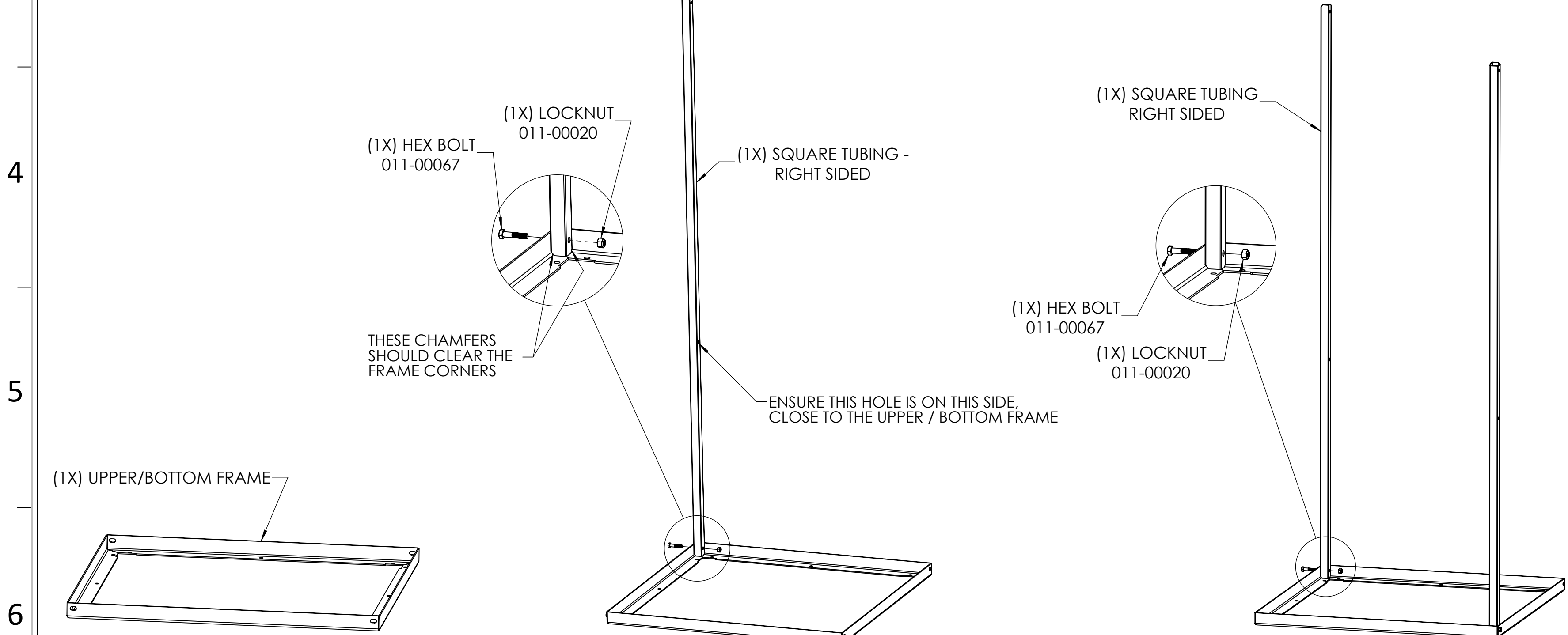

STEP 2: POSITION ONE UPPER/BOTTOM FRAME TO THE DESIRED INSTALLATION LOCATION.

STEP 3: INSTALL THE FIRST RIGHT SIDED TUBING AND SECURE IT WITH ONE HEX BOLT 011-00067 AND A LOCKNUT 011-00020. **DO NOT FULLY TIGHTEN THE BOLT.**

STEP 4: REPEAT STEP 3 TO INSTALL THE SECOND RIGHT SIDED TUBING. **DO NOT FULLY TIGHTEN THE BOLT.**



Confidentialité et politiques
Ce document est la propriété ZAXE TECHNOLOGIES et ne peut être utilisé pour d'autres fins que celles pour lesquelles il a été préparé et soumis. Aucune reproduction ne peut être faite sans autorisation.

The information contained in this drawing is the sole property of zaxe technologies. Any reproduction in part or as a whole without the written permission is prohibited.

©2019 Tous les droits réservés /All rights reserved.

No. de produit / Product Part Number:

450-00080

Designation du produit / Product Name

FEED WEIGHER

Titre du dessin / Drawing Title

INSTALLATION GUIDE

Révision / Revision Feuille / Sheet:

A 3 / 10

Matériau / Material specifications:

N/A

Unités / Units:

mm[in]

Standard Tolerances:

Inches

X/X ± 1/16"

X.XX" ±0.03"

X.XXX" ±0.010"

Millimeters

X.X ± 0.8

X.XX ±0.25

Angle

X.X° ± 0.5°

Dernière mise à jour / Last update date:

2021-01-20

Dessiné par / Drawn by:

U

Approuvé par / Approved by:

INSTALLATION PROCEDURE

1

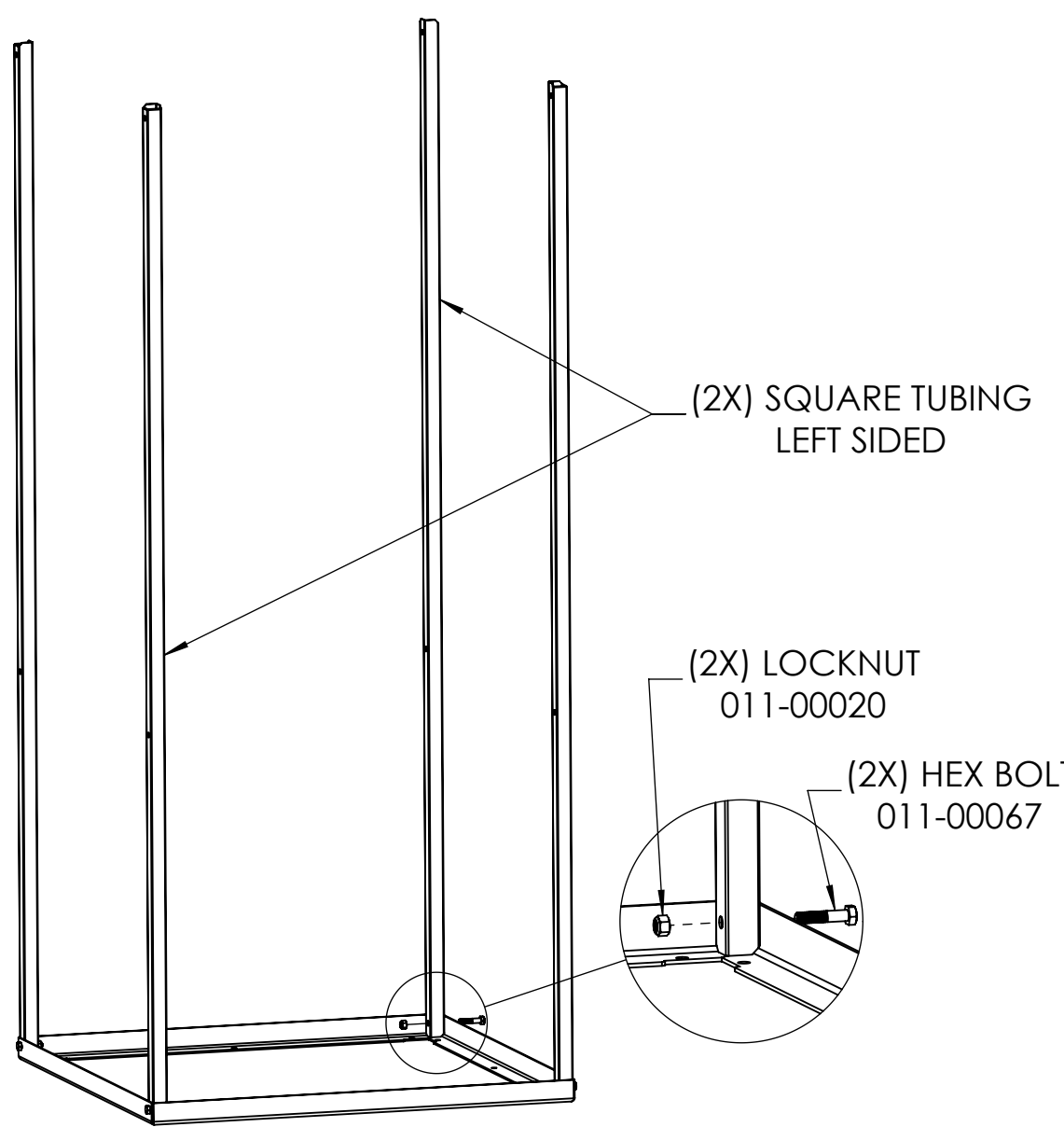

2

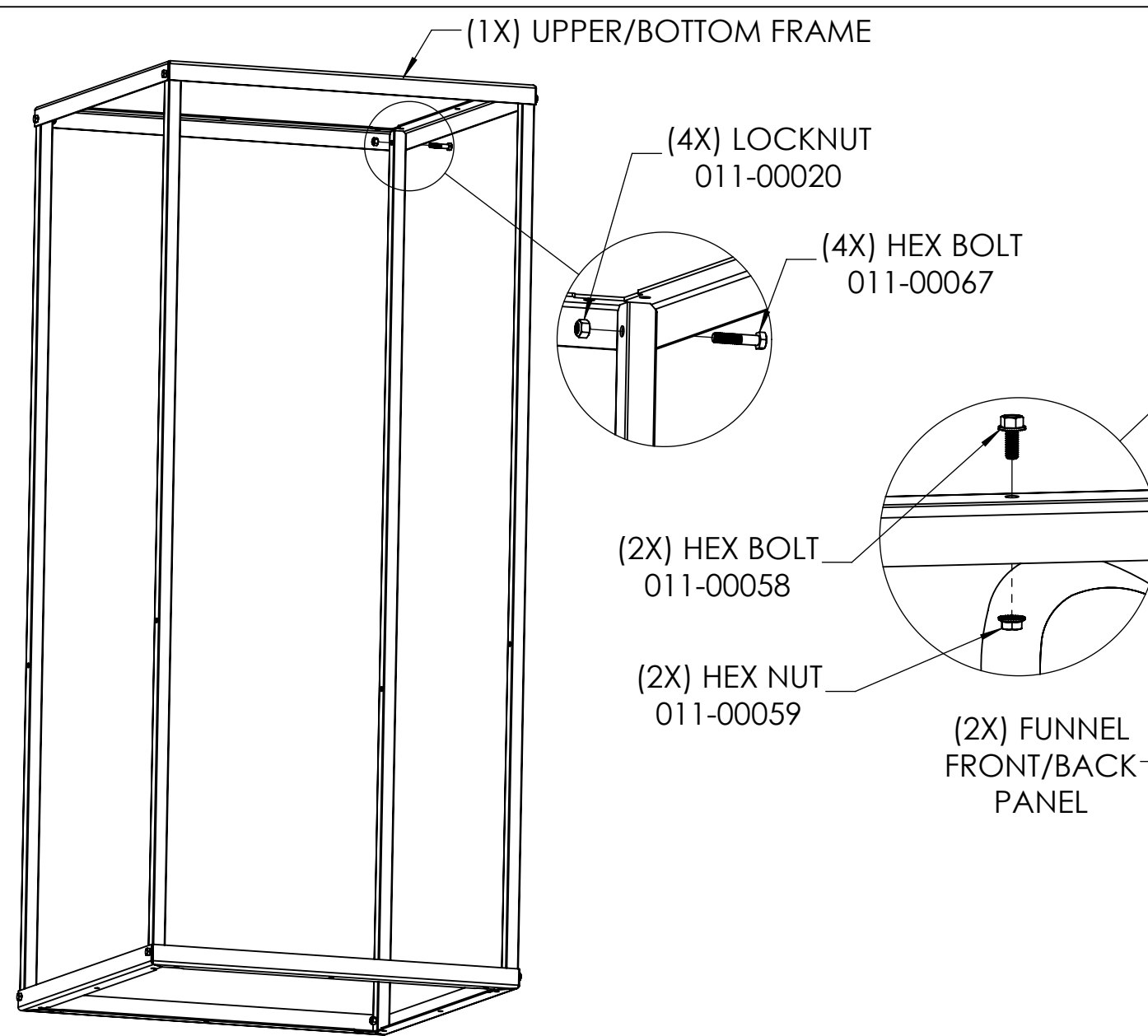

3

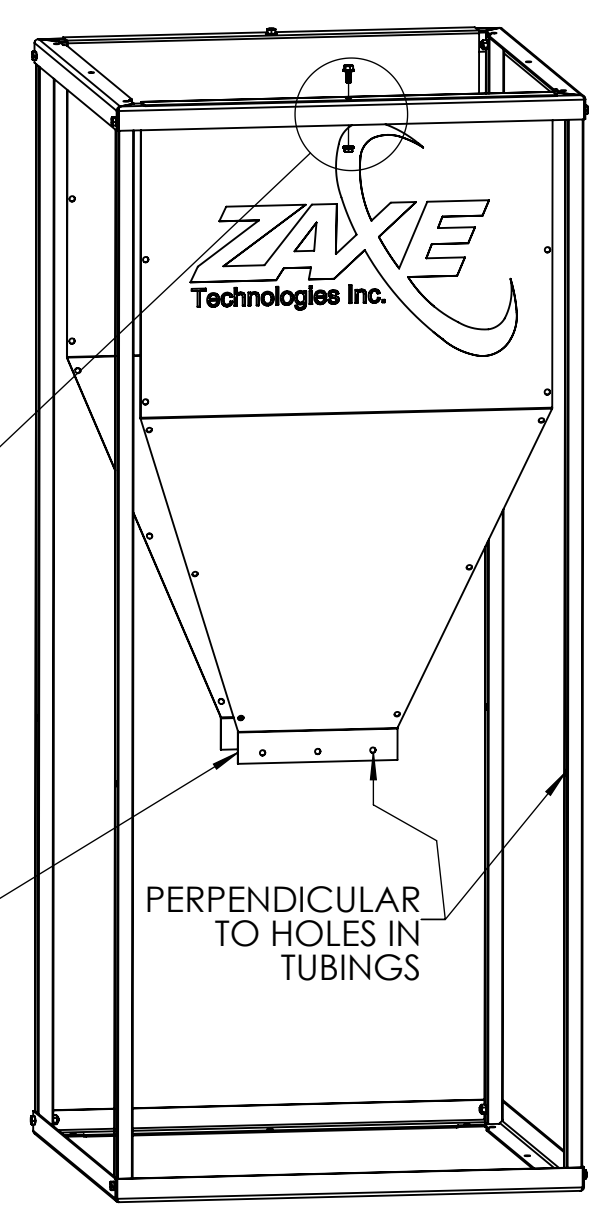

STEP 5: REPEAT **STEPS 3 AND 4** TO INSTALL THE TWO LEFT SIDED TUBINGS. **DO NOT FULLY TIGHTEN THE BOLTS.**

STEP 6: INSTALL THE SECOND TOP/BOTTOM FRAME AND SECURE IT WITH 4 HEX BOLT 011-00067 AND LOCKNUTS 011-00020. **DO NOT FULLY TIGHTEN THE BOLTS.**

STEP 7: SLIDE THE TWO FUNNEL FRONT/BACK PANELS INTO POSITION AND SECURE THEM WITH 2 HEX BOLT 011-00058 AND HEX NUTS 011-00059. **DO NOT FULLY TIGHTEN THE BOLTS.**

4

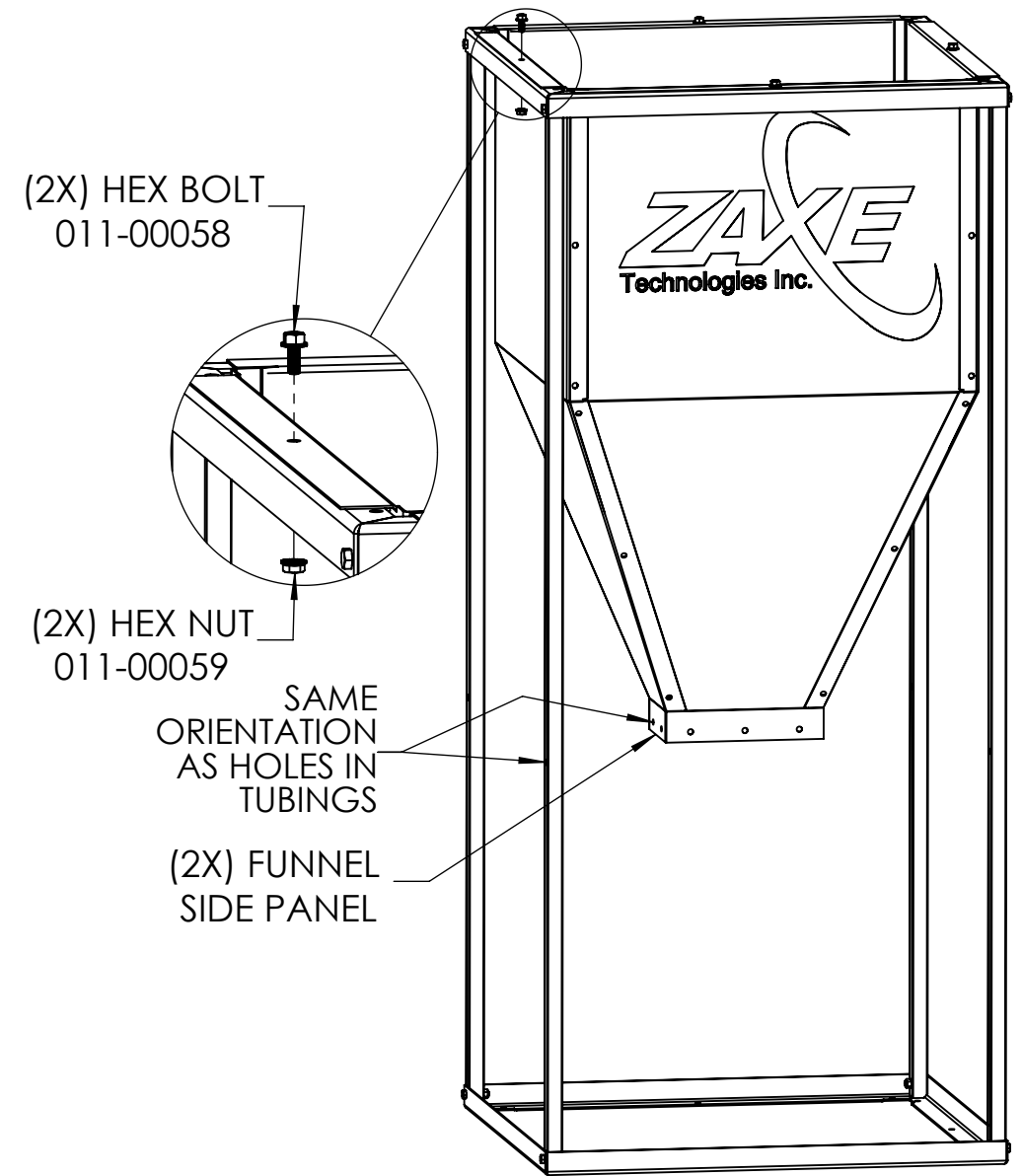

5

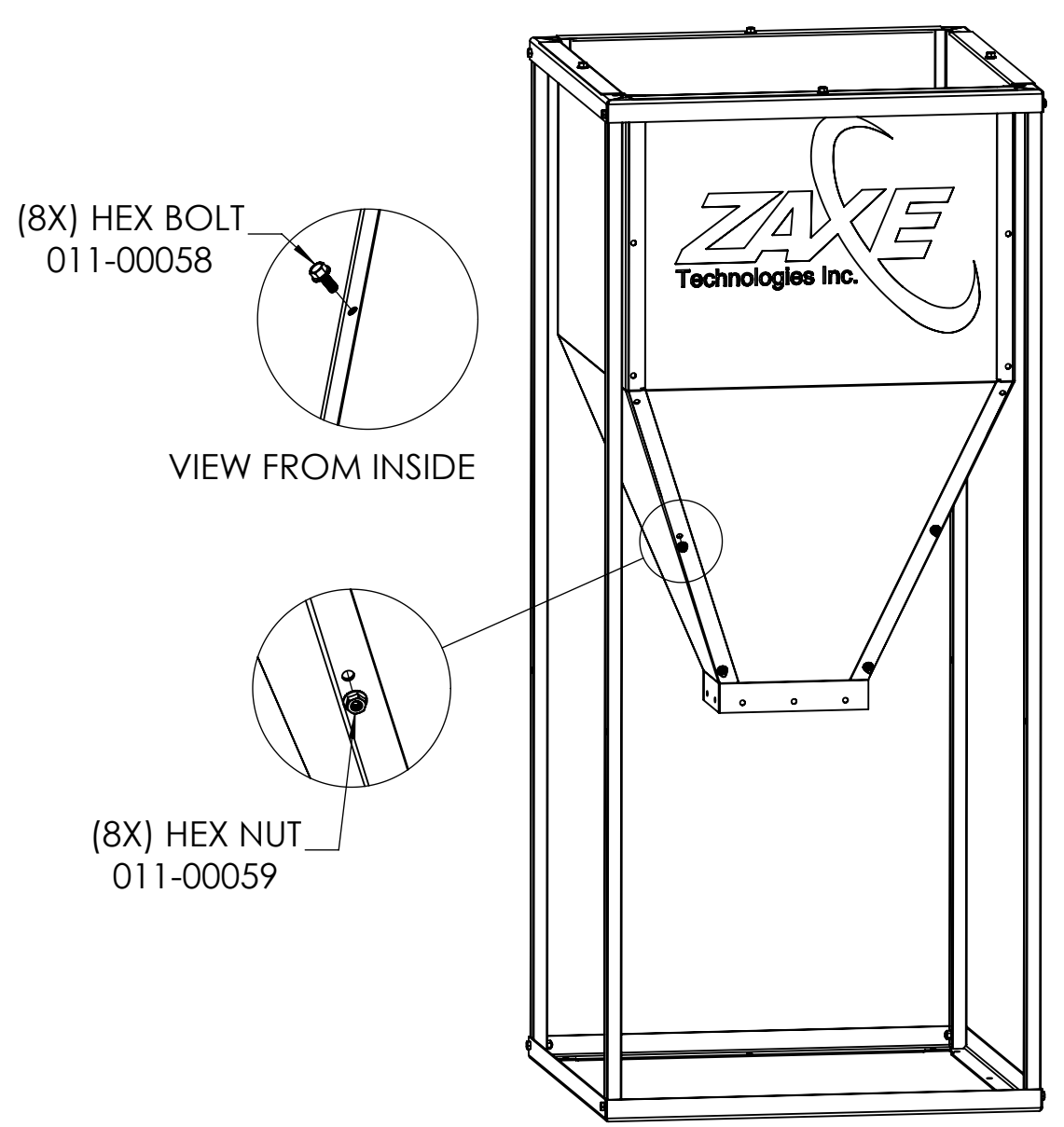

STEP 8: INSTALL THE TWO FUNNEL SIDE PANELS AND SECURE THEM WITH 2 HEX BOLT 011-00058 AND HEX NUTS 011-00059. **DO NOT FULLY TIGHTEN THE BOLTS.**

STEP 9a: FROM THE BOTTOM, INSTALL 8 HEX BOLT 011-00058 AND HEX NUTS 011-00059 FOR THE LOWER SIDE OF THE FUNNEL PANELS. **DO NOT FULLY TIGHTEN THE BOLTS.**

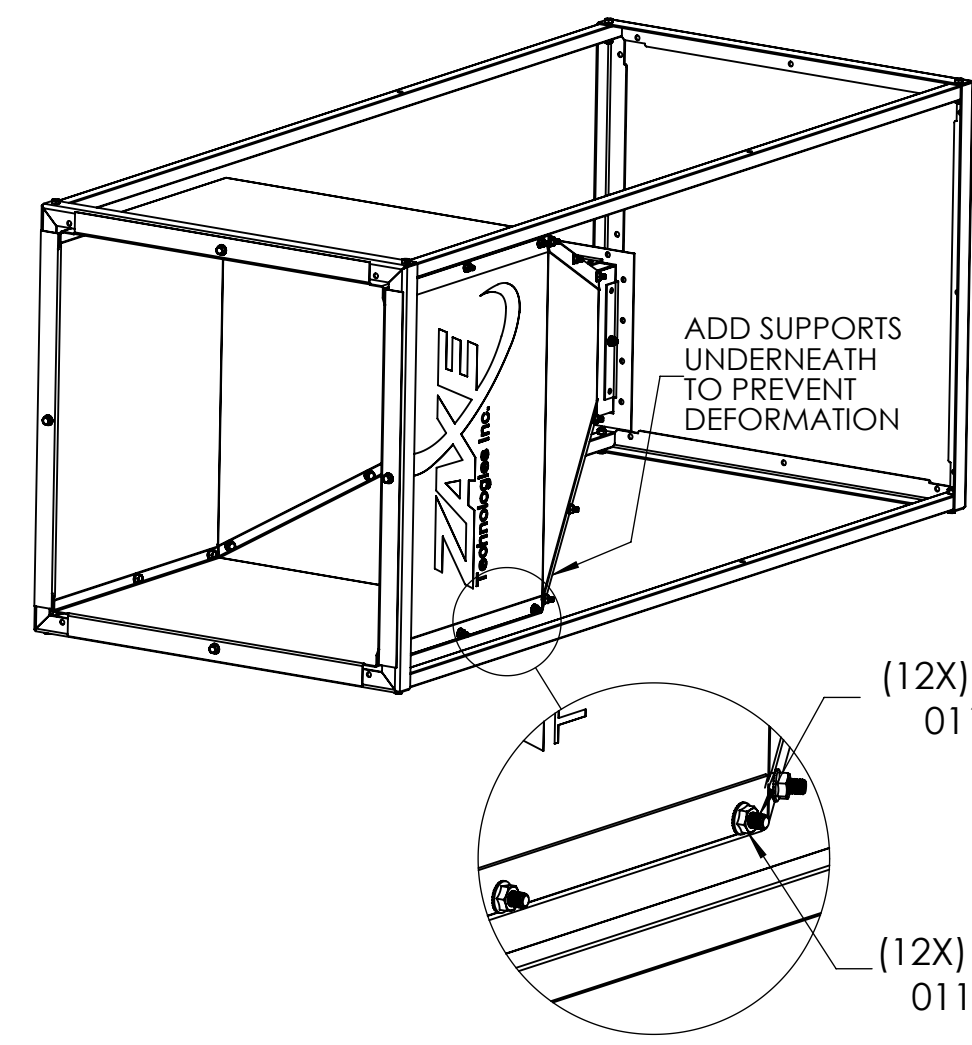

STEP 9b: CAREFULLY LAY THE ASSEMBLY ON THE SIDE AS SHOWN AND INSTALL THE REMAINING 12 HEX BOLTS 011-00058 AND HEX NUTS 011-00059. **FULLY TIGHTEN THESE 12 BOLTS AS WELL THOSE FOR THE TUBINGS AND UPPER/LOWER FRAME.**



Confidentialité et politiques
Ce document est la propriété ZAXE TECHNOLOGIES et ne peut être utilisé pour d'autres fins que celles pour lesquelles il a été préparé et soumis. Aucune reproduction ne peut être faite sans autorisation.

The information contained in this drawing is the sole property of zaxe technologies. Any reproduction in part or as a whole without the written permission is prohibited.

©2019 Tous les droits réservés /All rights reserved.

No. de produit / Product Part Number:

450-00080

Designation du produit / Product Name

FEED WEIGHER

Titre du dessin / Drawing Title

INSTALLATION GUIDE

Révision / Revision Feuille / Sheet:

A 4 / 10

Matériau / Material specifications:

N/A

Unités / Units:

mm[in]

Standard Tolerances:

Inches
X/X ± 1/16"
X.XX" ±0.03"
X.XXX" ±0.010"

Millimeters
X.X ± 0.8
X.XX ±0.25

Angle
X.X° ± 0.5°

Dernière mise à jour / Last update date:

2021-01-20

Dessiné par / Drawn by:

U

Approuvé par /Approved by:

INSTALLATION PROCEDURE

1
2
3
4
5
6

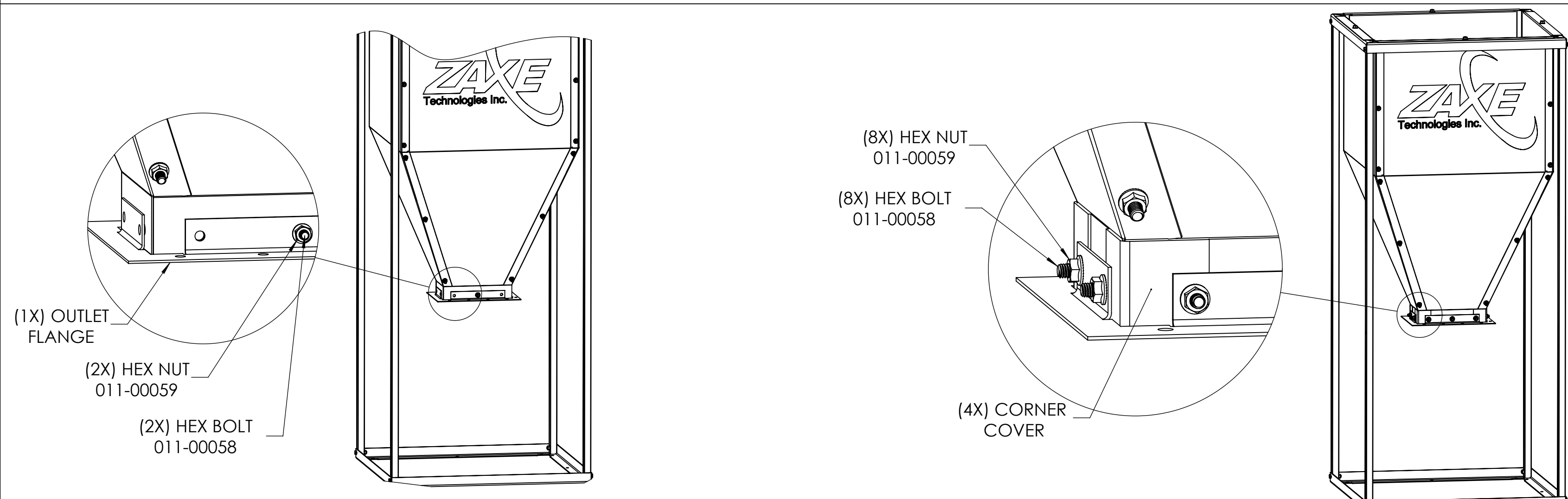

STEP 10: FROM THE BOTTOM OF THE FUNNEL ASSEMBLY, INSERT THE FUNNEL OUTLET FLANGE AND INSTALL, **THROUGH THE MIDDLE MOUNTING HOLES ONLY**, 2 HEX BOLTS 011-00058 AND HEX NUTS 011-00059 TO HOLD IT IN POSITION. **DO NOT FULLY TIGHTEN THE BOLTS.**

STEP 11: SLIDE IN THE 4 CORNER COVERS AND INSTALL THE REMAINING 8 HEX BOLTS 011-00058 AND HEX NUTS 011-00059 TO SECURE THE FLANGE. **DO NOT FULLY TIGHTEN THE BOLTS.**

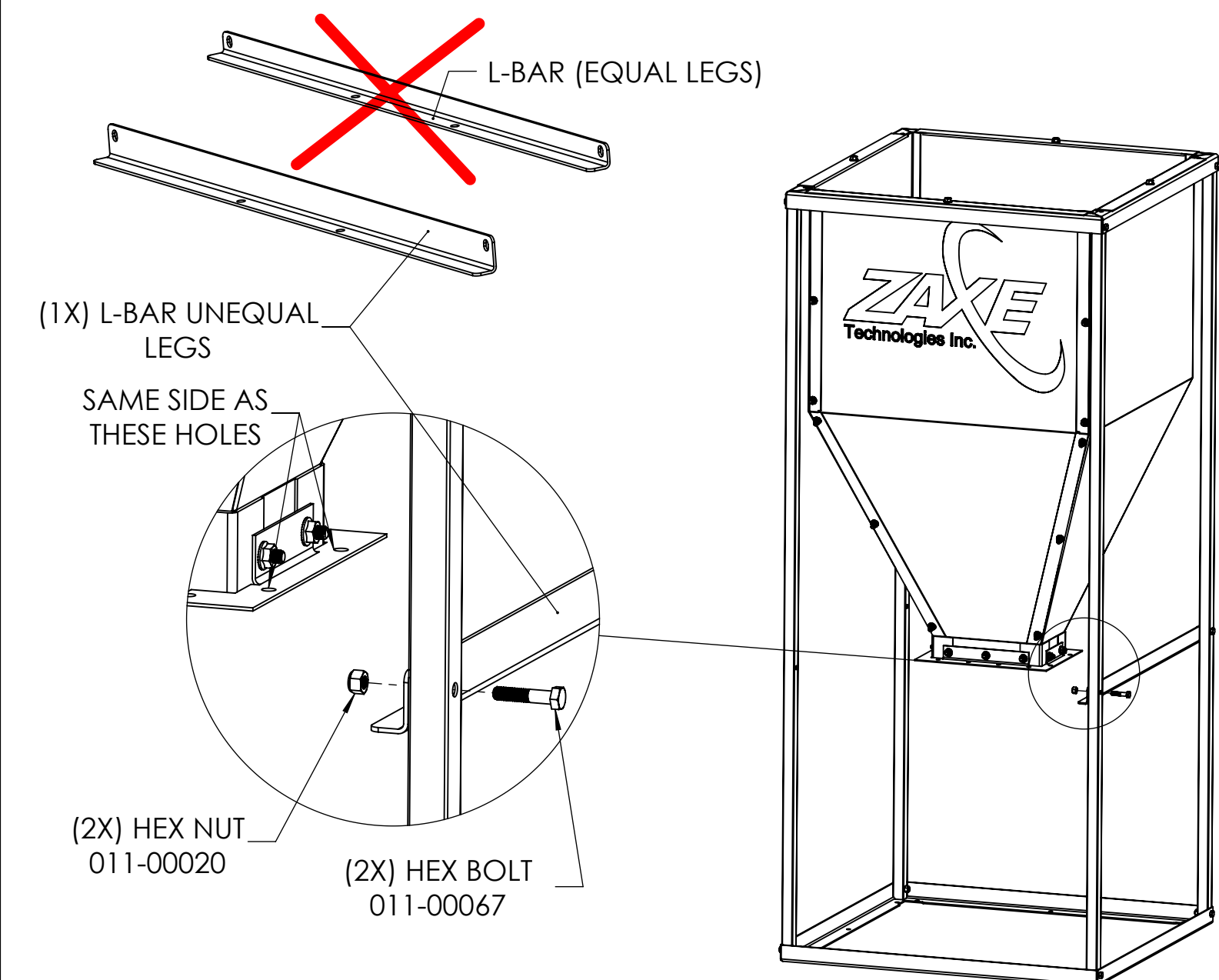

STEP 12: INSTALL THE L-BAR WITH UNEQUAL LEGS ON THE TUBINGS USING 2 HEX BOLTS 011-00067 AND LOCKNUTS 011-00020. **THIS L-BAR MUST BE ON THE SAME SIDE AS THE 2 MOUNTING HOLES OF THE OUTLET FLANGE AS SHOWN. DO NOT FULLY TIGHTEN THE BOLTS.**

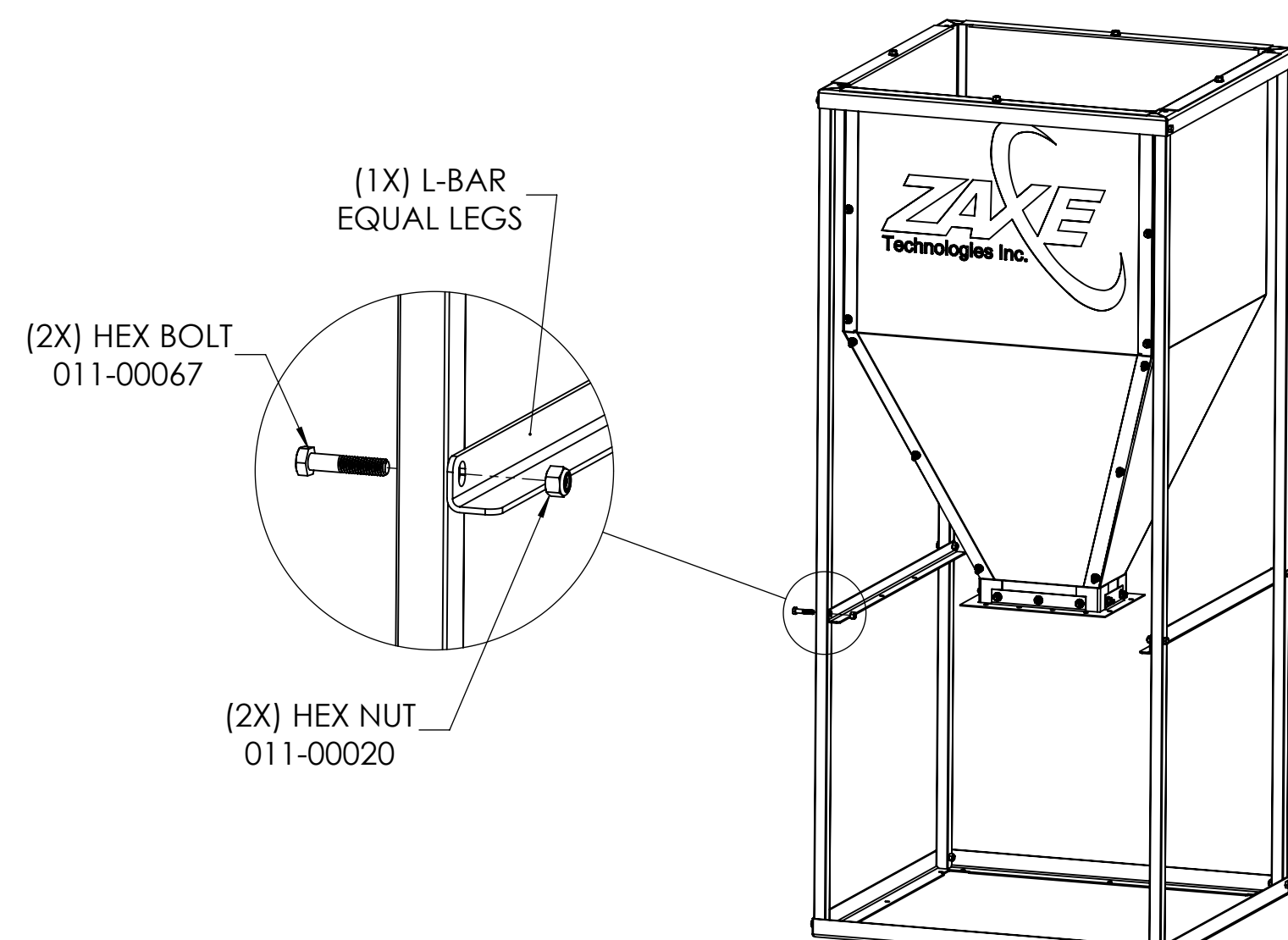

STEP 13: REPEAT STEP 12 TO INSTALL THE L-BAR WITH EQUAL LEGS ON THE TUBINGS AS SHOWN. **DO NOT FULLY TIGHTEN THE BOLTS.**



Confidentialité et politiques
Ce document est la propriété ZAXE TECHNOLOGIES et ne peut être utilisé pour d'autres fins que celles pour lesquelles il a été préparé et soumis. Aucune reproduction ne peut être faite sans autorisation.

The information contained in this drawing is the sole property of zaxe technologies. Any reproduction in part or as a whole without the written permission is prohibited.

©2019 Tous les droits réservés /All rights reserved.

No. de produit / Product Part Number:

450-00080

Designation du produit / Product Name

FEED WEIGHER

Titre du dessin / Drawing Title

INSTALLATION GUIDE

Révision / Revision Feuille / Sheet:

A 5 / 10

Matériau / Material specifications:

N/A

Unités / Units:

mm[in]

Standard Tolerances:

Inches
X/X ± 1/16"
X.XX" ±0.03"
X.XXX" ±0.010"

Millimeters
X.X ± 0.8
X.XX ±0.25

Angle
X.X° ± 0.5°

Dernière mise à jour / Last update date:

2021-01-20

Dessiné par / Drawn by:

LJ

Approuvé par /Approved by:

INSTALLATION PROCEDURE

1
2
3
4
5
6

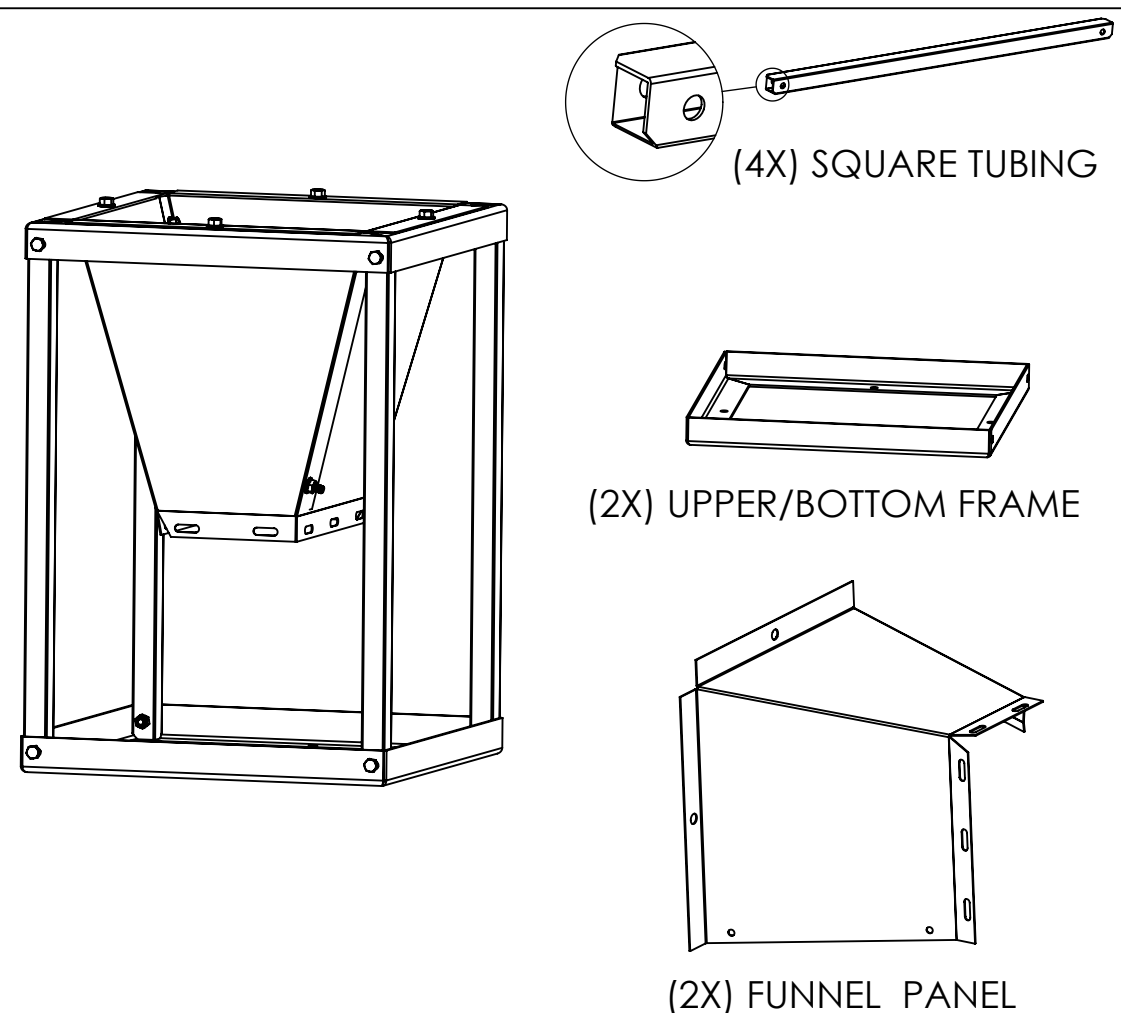

- (8X) HEX BOLT, 1 1/2" 011-00067
- (8X) SERRATED FLANGED HEX BOLT, 3/4" 011-00058
- (8X) SERRATED FLANGED HEX NUT - 011-00059
- (8X) LOCKNUT 011-00020

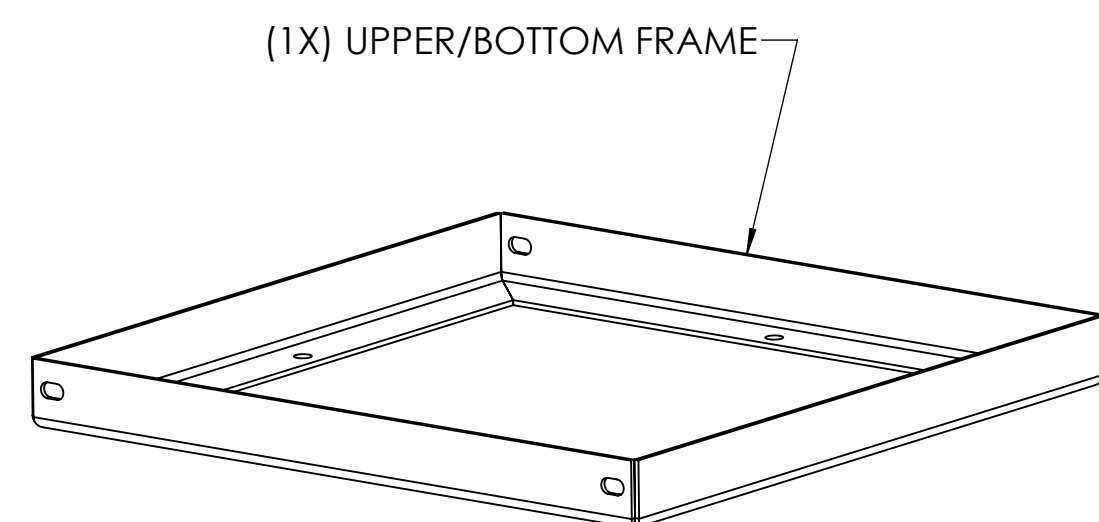

STEP 14: RECEIVING BIN ASSEMBLY. ENSURE THAT ALL THE PARTS LISTED ABOVE ARE AVAILABLE BEFORE BEGINNING THE ASSEMBLY. **SKIP THIS STEP AND THE SUBSEQUENT STEPS IF THE BIN IS SUPPLIED PRE-ASSEMBLED, GO TO STEP 24.**

STEP 15: POSITION ONE UPPER/BOTTOM FRAME TO THE DESIRED INSTALLATION LOCATION.

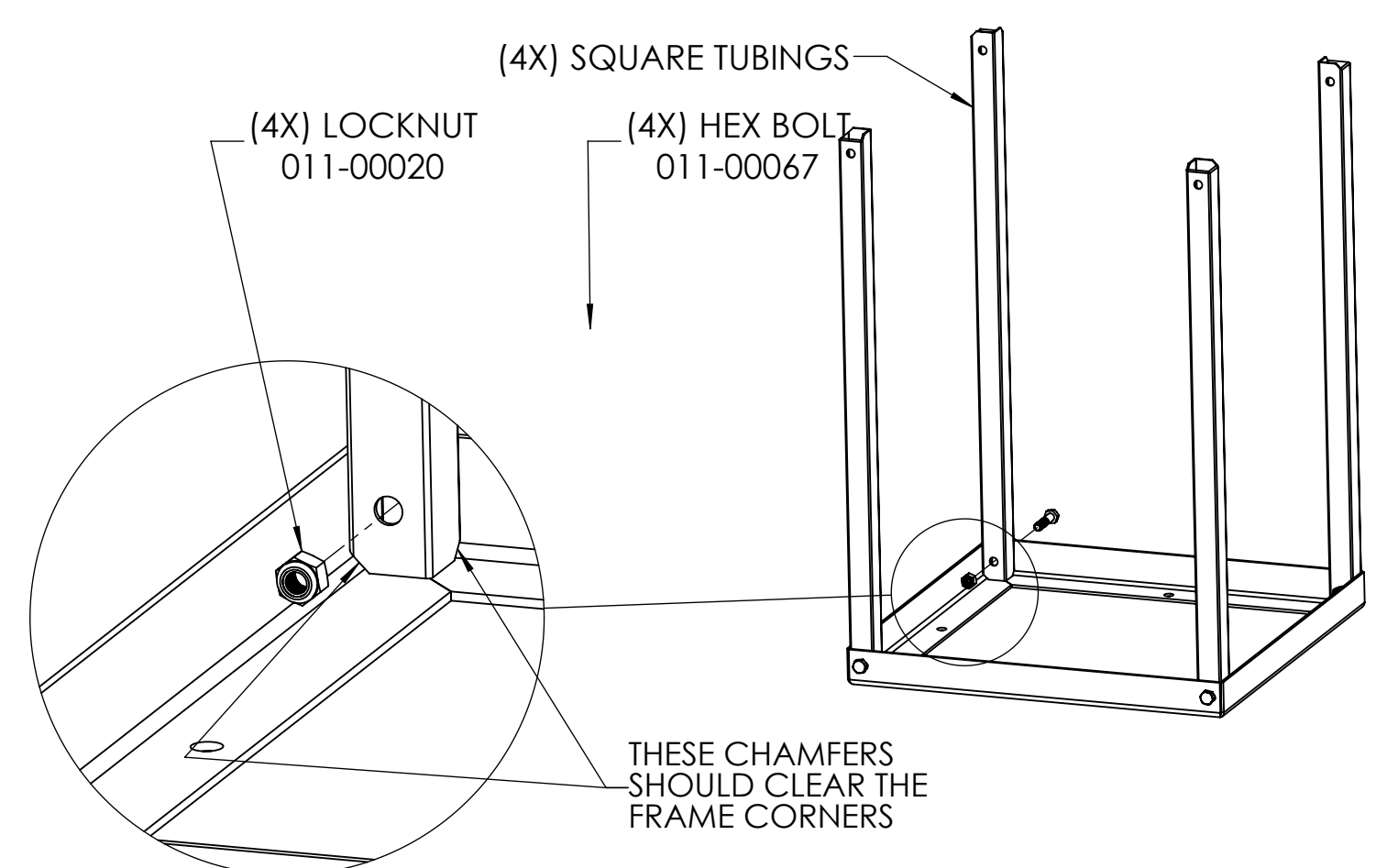

STEP 16: INSTALL THE 4 SQUARE TUBING AND SECURE EACH WITH ONE HEX BOLT 011-00067 AND LOCKNUT 011-00020. **DO NOT FULLY TIGHTEN THE BOLTS.**

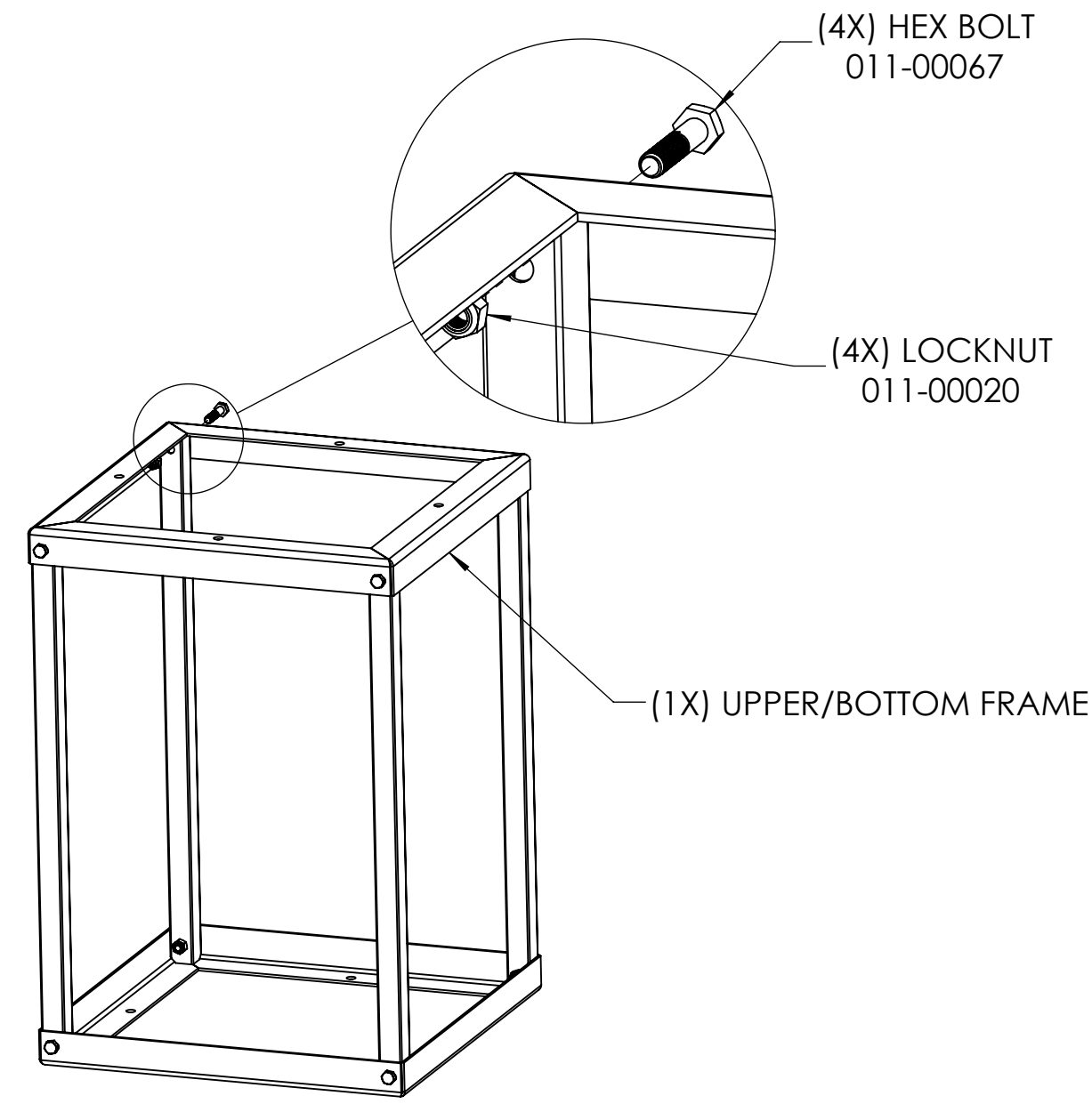

STEP 17: REPEAT STEP 16 TO INSTALL THE SECOND UPPER/LOWER FRAME. USE 4 HEX BOLT 011-00067 AND LOCKNUTS 011-00020 TO SECURE IT TO THE TUBINGS. **DO NOT FULLY TIGHTEN THE BOLTS.**



Confidentialité et politiques
 Ce document est la propriété ZAXE TECHNOLOGIES et ne peut être utilisé pour d'autres fins que celles pour lesquelles il a été préparé et soumis. Aucune reproduction ne peut être faite sans autorisation.

The information contained in this drawing is the sole property of zaxe technologies. Any reproduction in part or as a whole without the written permission is prohibited.

©2019 Tous les droits réservés /All rights reserved.

No. de produit / Product Part Number:

450-00080

Designation du produit / Product Name

FEED WEIGHER

Titre du dessin / Drawing Title

INSTALLATION GUIDE

Révision / Revision Feuille / Sheet:

A 6 / 10

Matériau / Material specifications:

N/A

Unités / Units:

mm[in]

Standard Tolerances:

Inches

X/X ± 1/16"

X.XX" ±0.03"

X.XXX" ±0.010"

Millimeters

X.X ± 0.8

X.XX ±0.25

Angle

X.X° ± 0.5°

Dernière mise à jour / Last update date:

2021-01-20

Dessiné par / Drawn by:

U

Approuvé par /Approved by:

INSTALLATION PROCEDURE

1

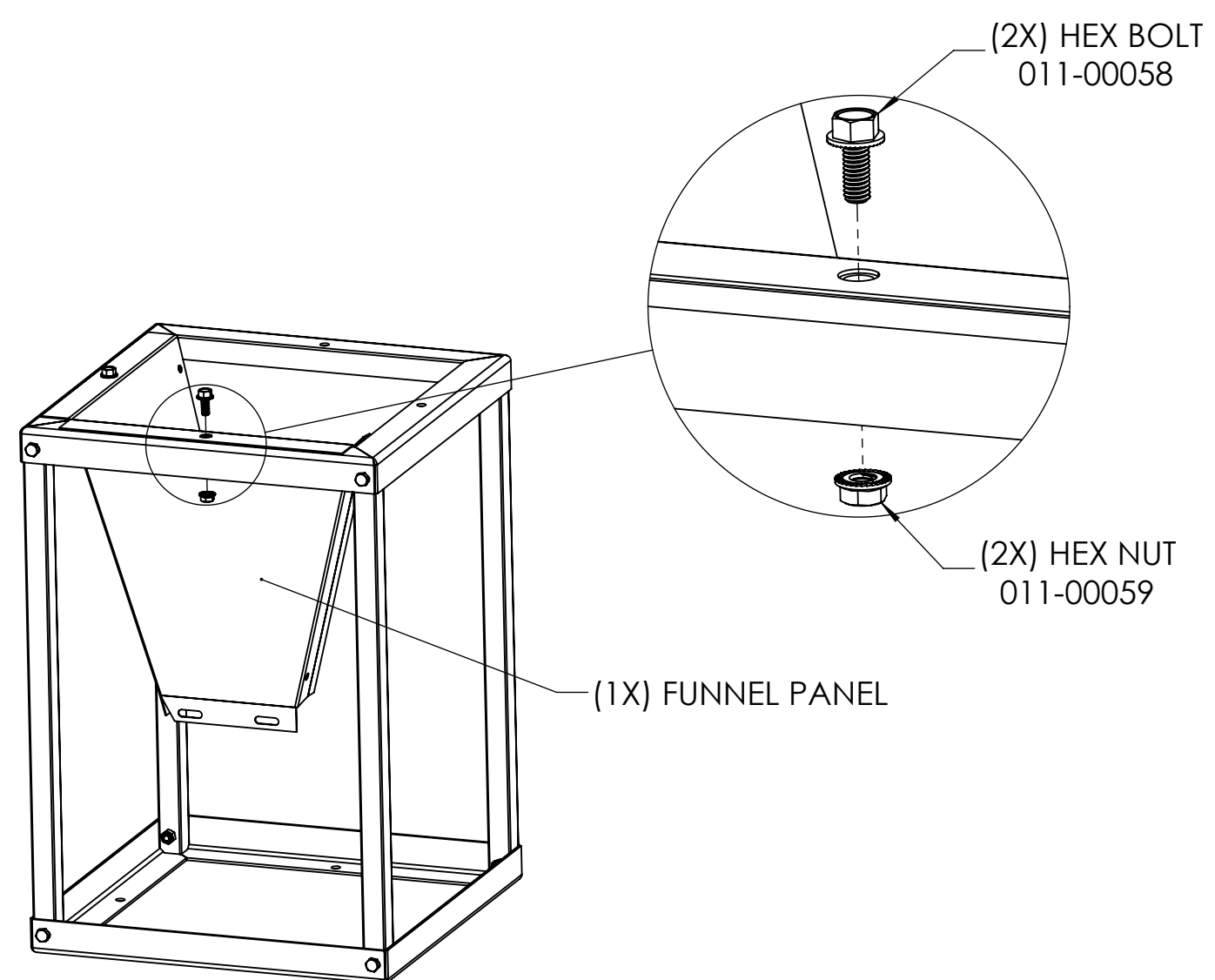

STEP 18: INSTALL THE FIRST FUNNEL PANEL USING 2 HEX BOLT 011-00058 AND HEX NUTS 011-00059. **DO NOT FULLY TIGHTEN THE BOLTS.**

2

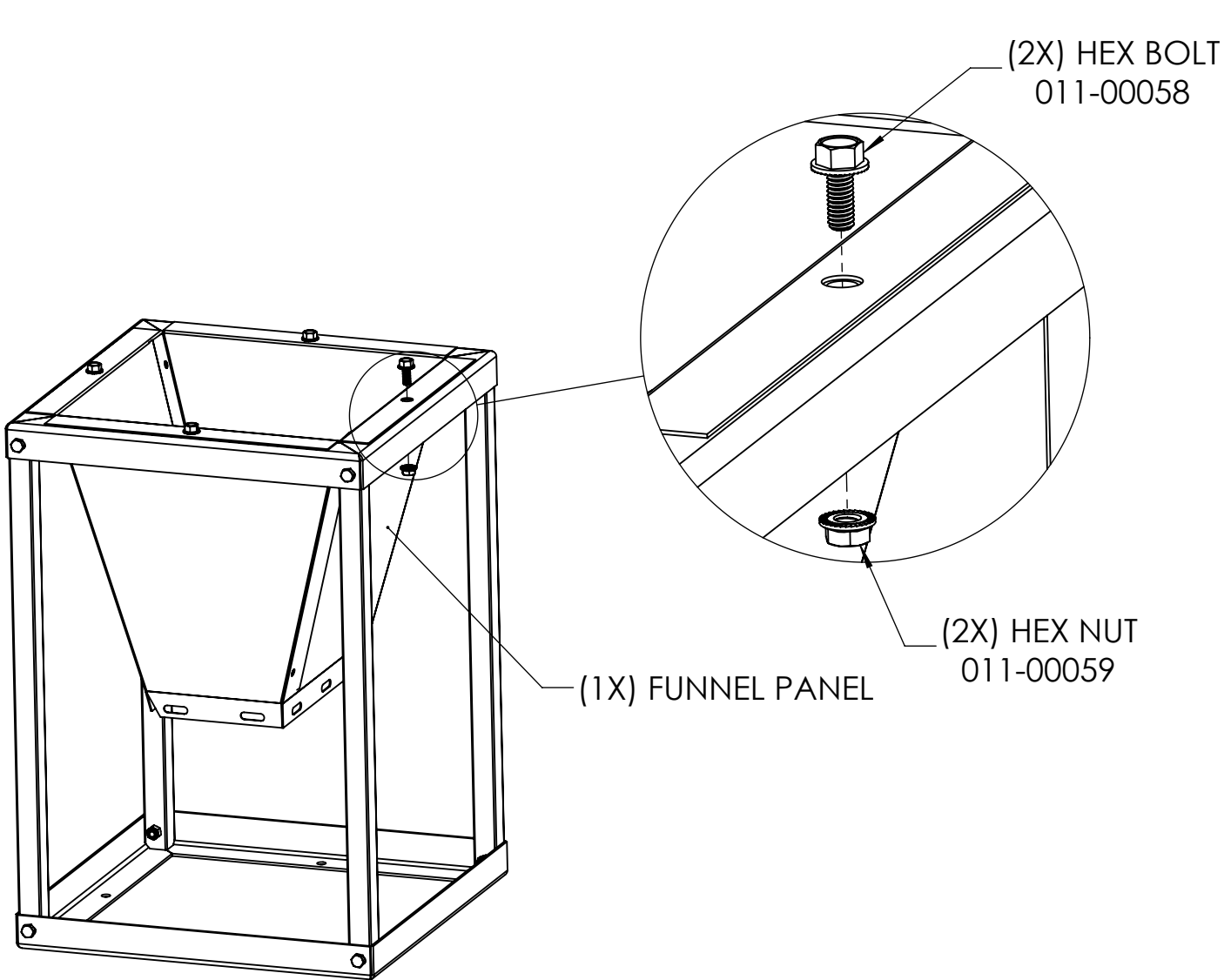

STEP 19: REPEAT STEP 18 TO INSTALL THE SECOND FUNNEL PANEL. **DO NOT FULLY TIGHTEN THE BOLTS.**

3

4

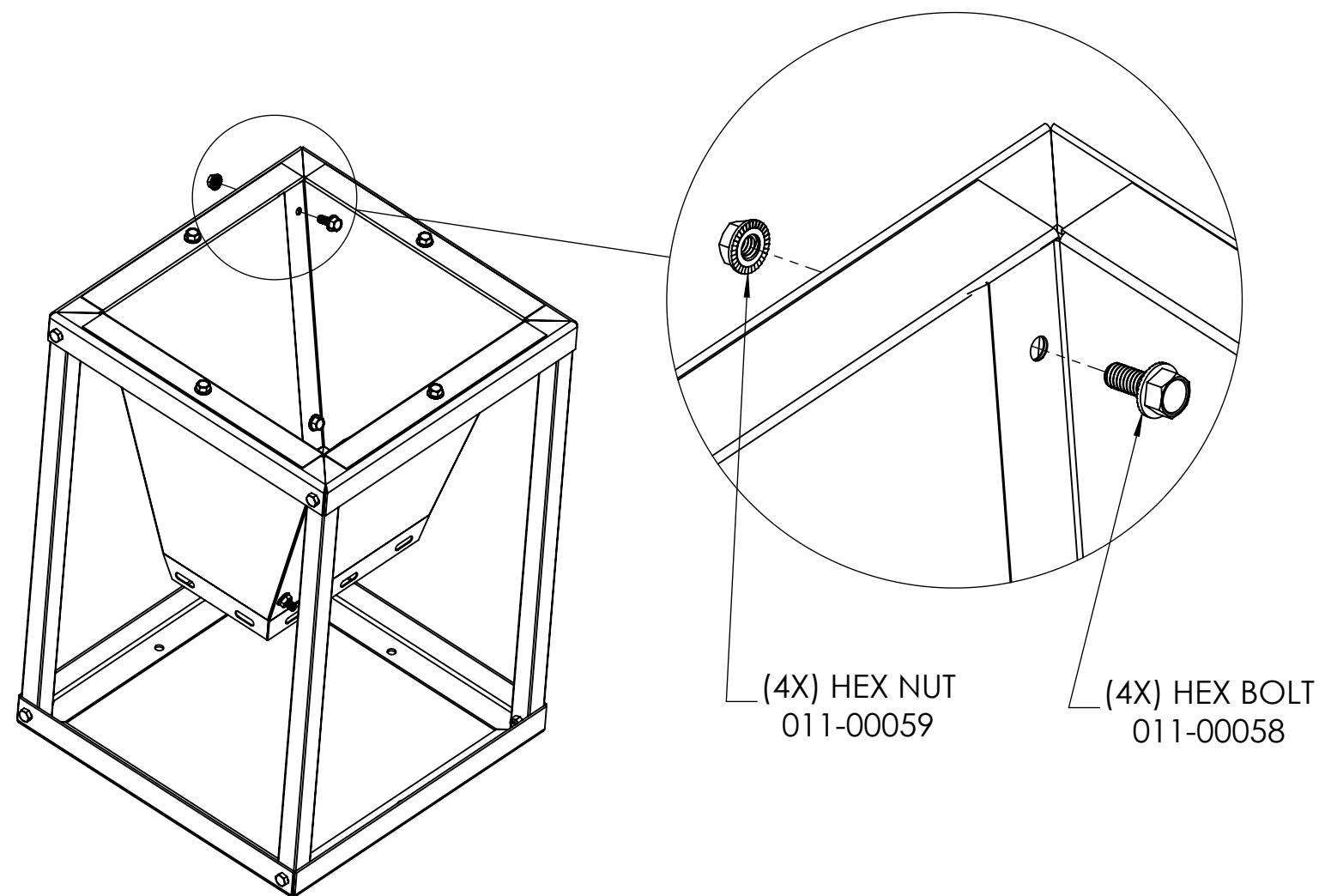

STEP 20: INSTALL 4 HEX BOLTS 011-00058 AND HEX NUTS 011-00059 TO FULLY SECURE THE 2 FUNNEL PANELS. **ALL THE BOLTS FOR THE RECEIVING BIN CAN NOW BE FULLY TIGHTEN.**

5

6



Confidentialité et politiques
Ce document est la propriété ZAXE TECHNOLOGIES et ne peut être utilisé pour d'autres fins que celles pour lesquelles il a été préparé et soumis. Aucune reproduction ne peut être faite sans autorisation.

The information contained in this drawing is the sole property of zaxe technologies. Any reproduction in part or as a whole without the written permission is prohibited.

©2019 Tous les droits réservés /All rights reserved.

No. de produit / Product Part Number:

450-00080

Designation du produit / Product Name

FEED WEIGHER

Titre du dessin / Drawing Title

INSTALLATION GUIDE

Révision / Revision Feuille / Sheet:

A 7 / 10

Matériau / Material specifications:

N/A

Unités / Units:

mm[in]

Standard Tolerances:

Inches

X/X ± 1/16"
X.XX" ±0.03"
X.XXX" ±0.010"

Millimeters

X.X ± 0.8
X.XX ± 0.25

Angle

X.X° ± 0.5°

Dernière mise à jour / Last update date:

2021-01-20

Dessiné par / Drawn by:

U

Approuvé par /Approved by:

INSTALLATION PROCEDURE

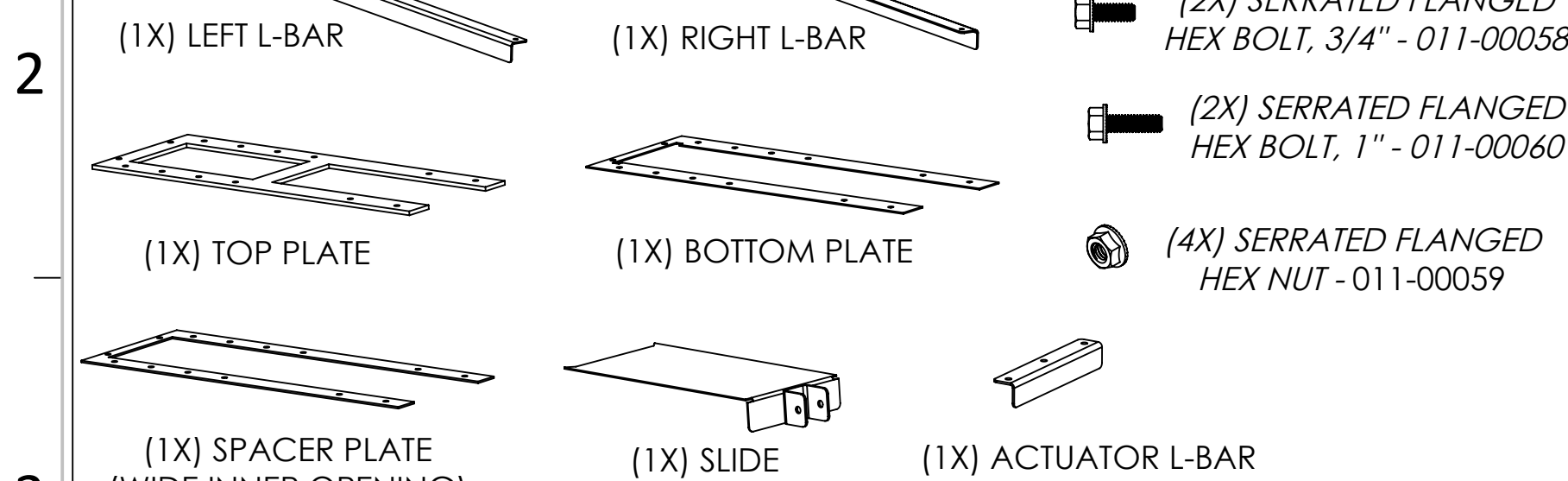
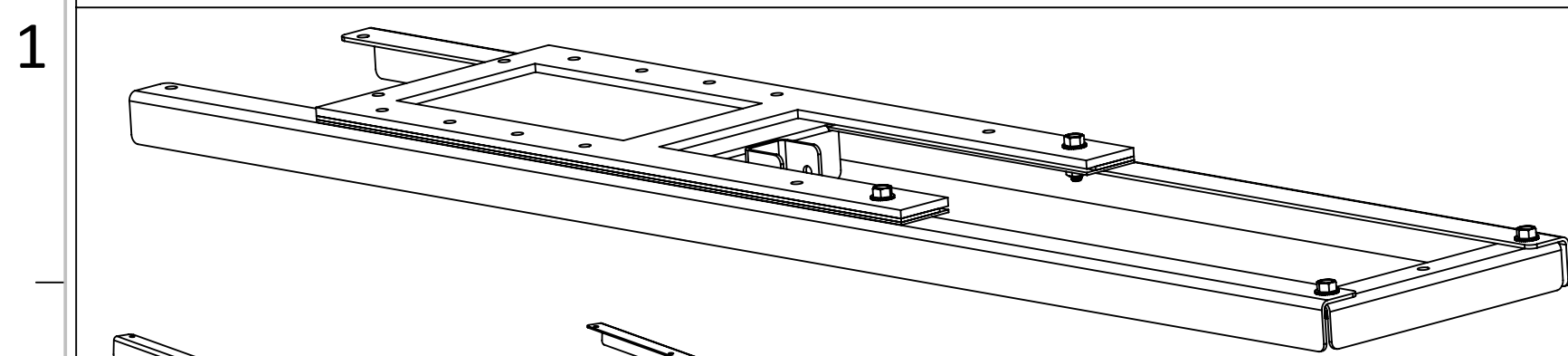

STEP 21: SLIDE GATE ASSEMBLY. ENSURE THAT ALL THE PARTS LISTED ABOVE ARE AVAILABLE BEFORE BEGINNING THE ASSEMBLY. **SKIP THIS STEP AND THE SUBSEQUENT STEPS IF THE SLIDER IS SUPPLIED PRE-ASSEMBLED, GO TO STEP 24.**

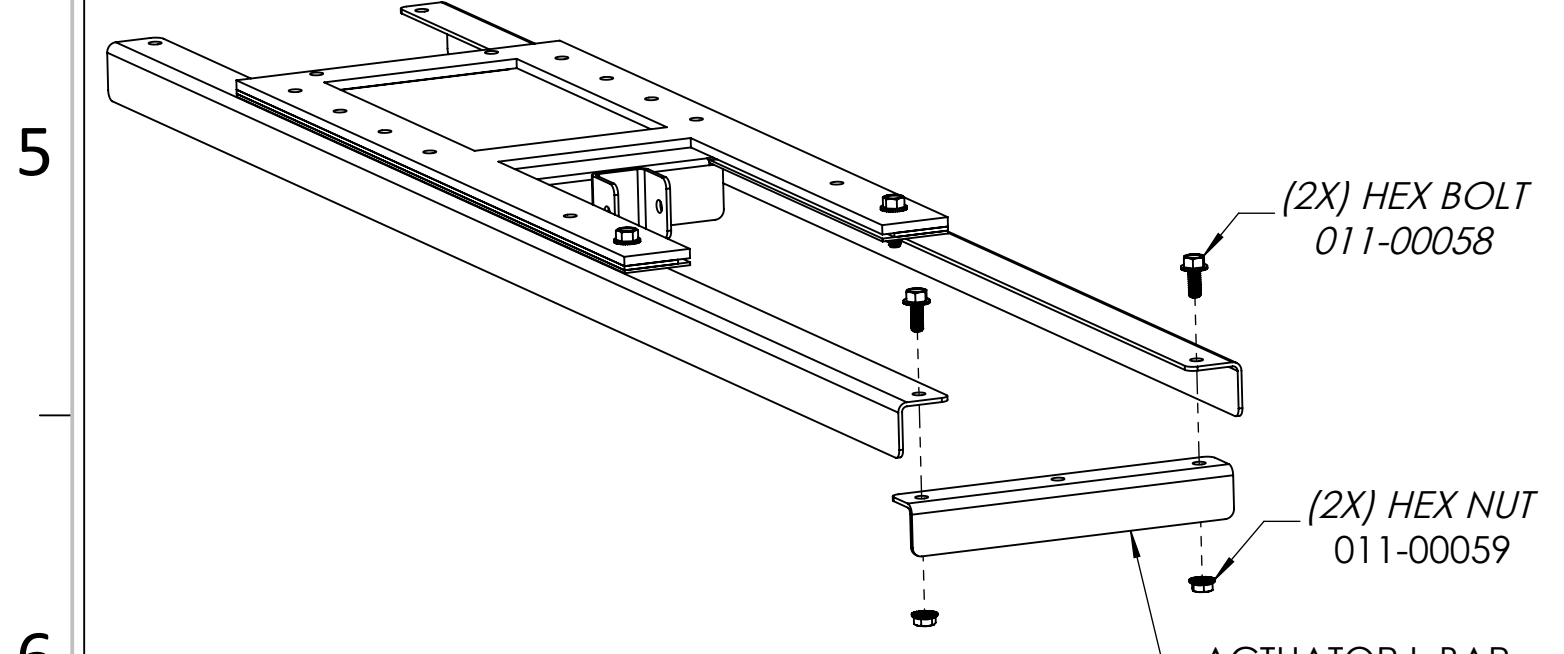
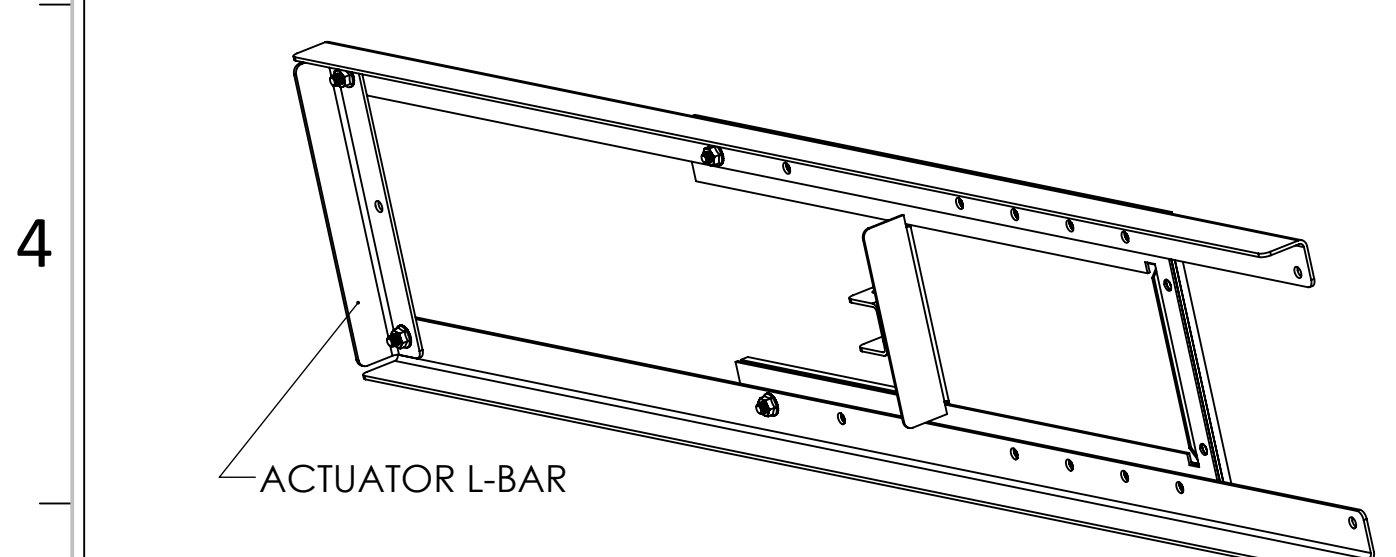

STEP 23: INSTALL THE ACTUATOR L-BAR AS SHOWN AND SECURE IT WITH 2 HEX BOLTS 011-00058 AND 2 HEX NUTS 011-00059. **DO NOT FULLY TIGHTEN THE BOLTS.**

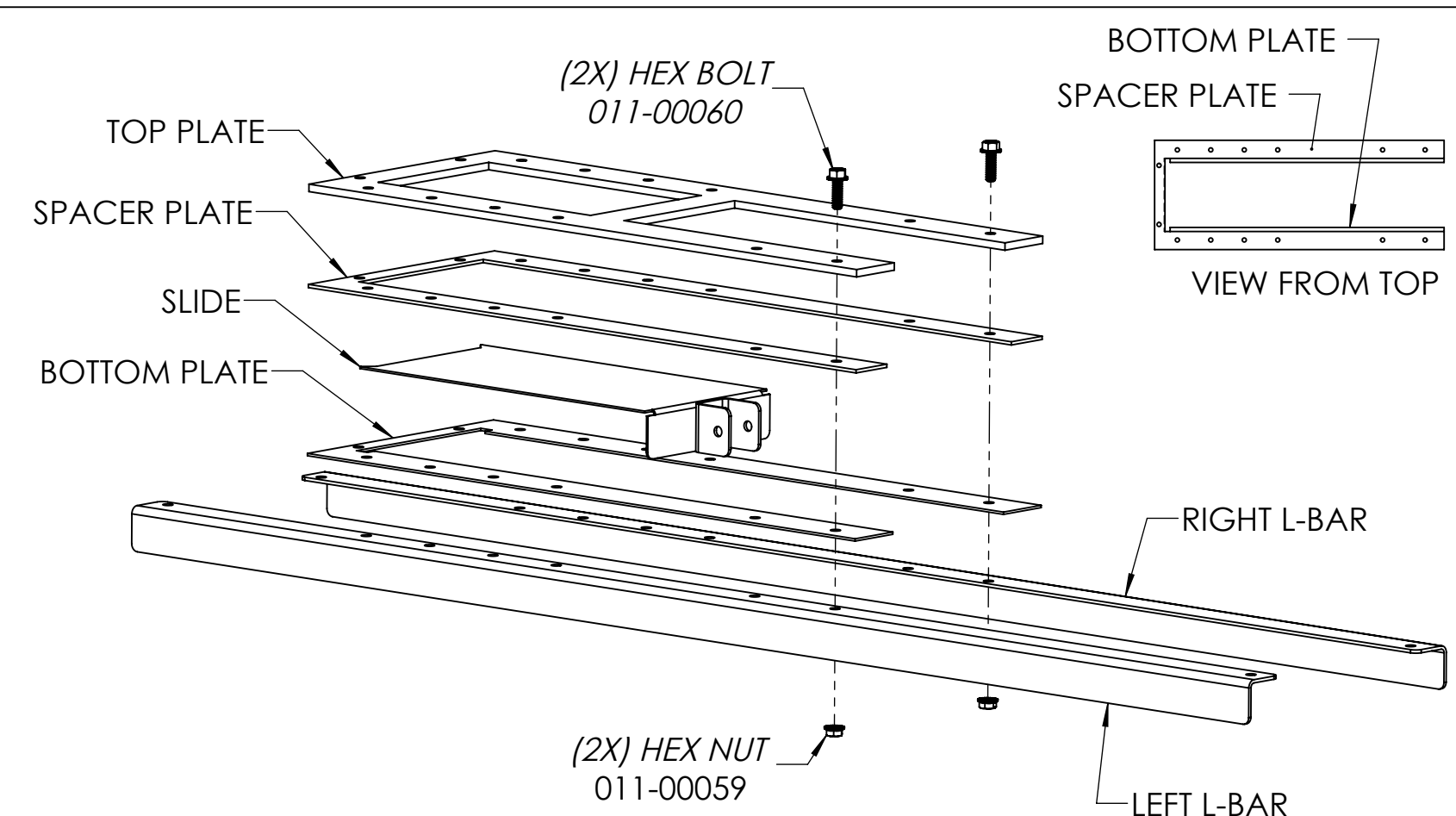

STEP 22: STACK THE PARTS IN THE INDICATED ORDER TO BUILD A GUIDE FOR THE SLIDE AND INSTALL 2 HEX BOLTS 011-00060 AND 2 HEX NUTS 011-00059 TO HOLD THEM IN PLACE. **DO NOT FULLY TIGHTEN THE BOLTS.**

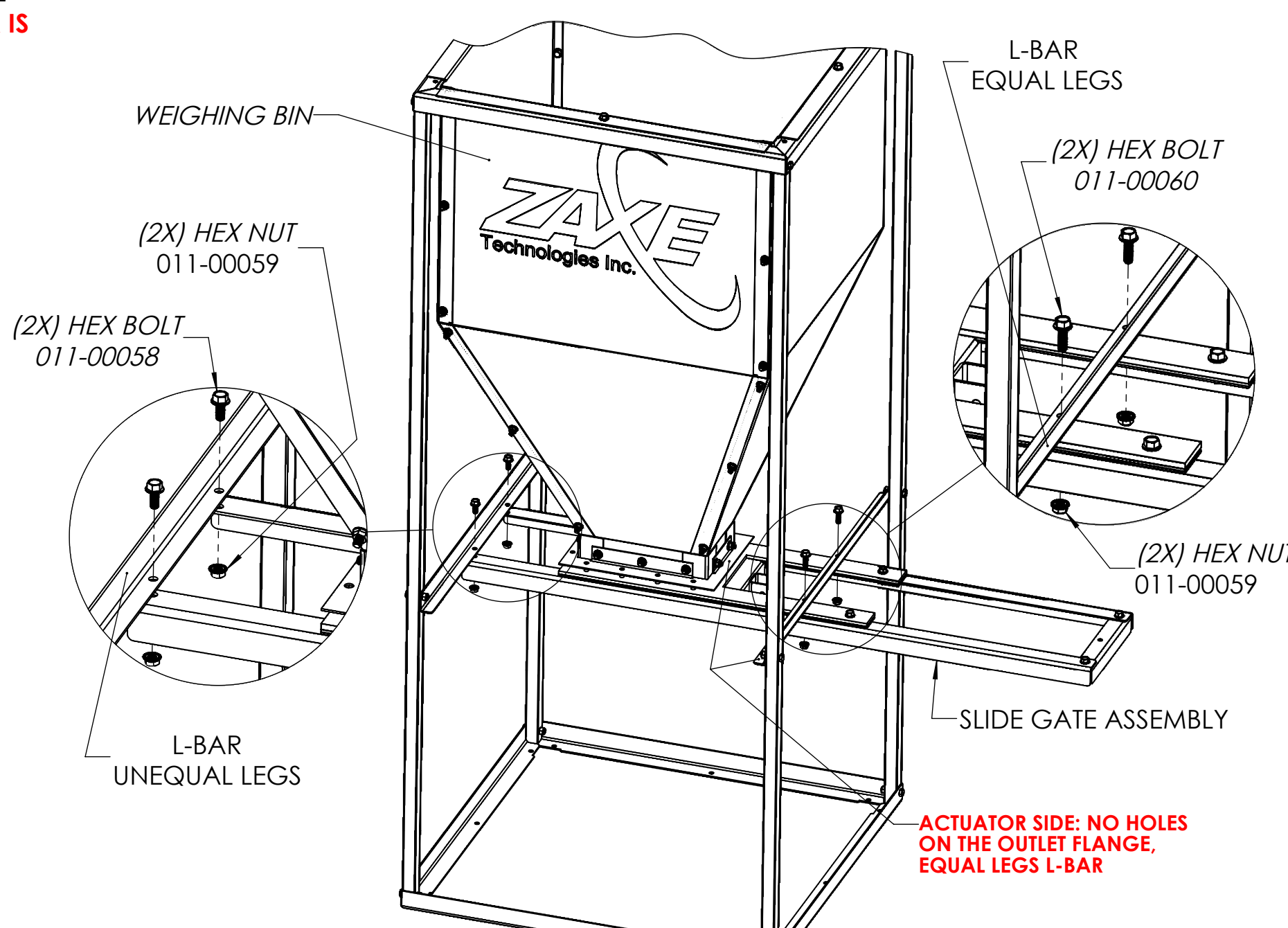

STEP 24: NOW INSTALL THE SLIDE GATE ASSEMBLY ONTO THE WEIGHING BIN:
- FOR THE ACTUATOR SIDE (RIGHT SIDE HERE), USE 2 HEX BOLTS 011-00060 AND 2 HEX NUTS 011-00059 TO SECURE IT ON THE L-BAR WITH EQUAL LEGS.
- FOR THE OTHER SIDE, USE 2 HEX BOLTS 011-00058 AND 2 HEX NUTS 011-00059.
DO NOT FULLY TIGHTEN THE BOLTS.

ACTUATOR SIDE: NO HOLES ON THE OUTLET FLANGE, EQUAL LEGS L-BAR



Confidentialité et politiques
Ce document est la propriété ZAXE TECHNOLOGIES et ne peut être utilisé pour d'autres fins que celles pour lesquelles il a été préparé et soumis. Aucune reproduction ne peut être faite sans autorisation.

The information contained in this drawing is the sole property of zaxe technologies. Any reproduction in part or as a whole without the written permission is prohibited.

©2019 Tous les droits réservés /All rights reserved.

No. de produit / Product Part Number:

450-00080

Designation du produit / Product Name

FEED WEIGHER

Titre du dessin / Drawing Title

INSTALLATION GUIDE

Révision / Revision Feuille / Sheet:

A 8 / 10

Matériau / Material specifications:

N/A

Unités / Units:

mm[in]

Standard Tolerances:

Inches

X/X ± 1/16"

X.XX" ±0.03"

X.XXX" ±0.010"

Millimeters

X.X ± 0.8

X.XX ±0.25

Angle

X.X° ± 0.5°

Dernière mise à jour / Last update date:

2021-01-20

Dessiné par / Drawn by:

U

Approuvé par /Approved by:

INSTALLATION PROCEDURE

1

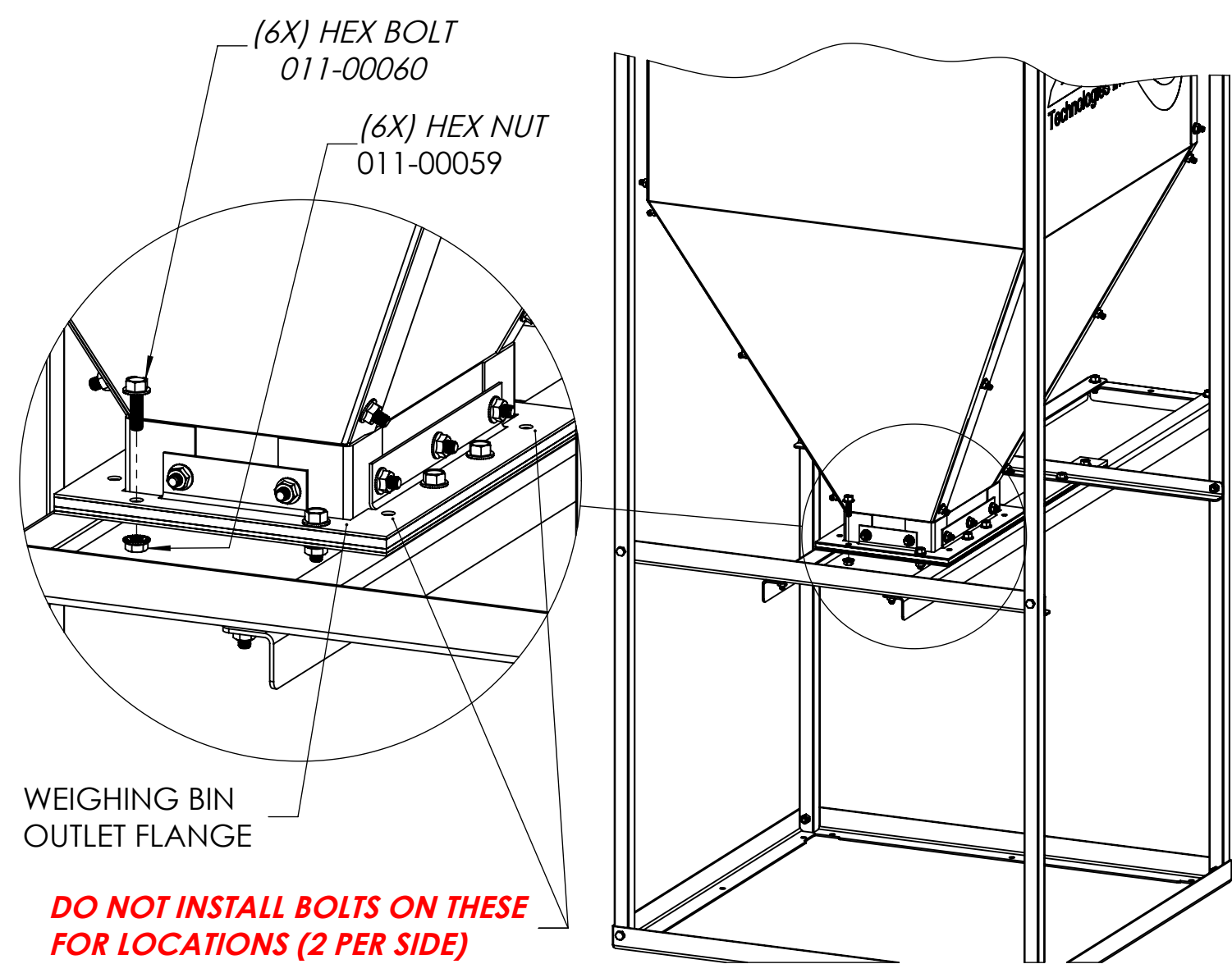

2

3

STEP 25: SECURE THE SLIDE GATE ASSEMBLY ONTO THE WEIGHING BIN OUTLET FLANGE USING 6 HEX BOLTS 011-00060 AND HEX NUTS 011-00059. **FULLY TIGHTEN ALL THE BOLTS.**

4

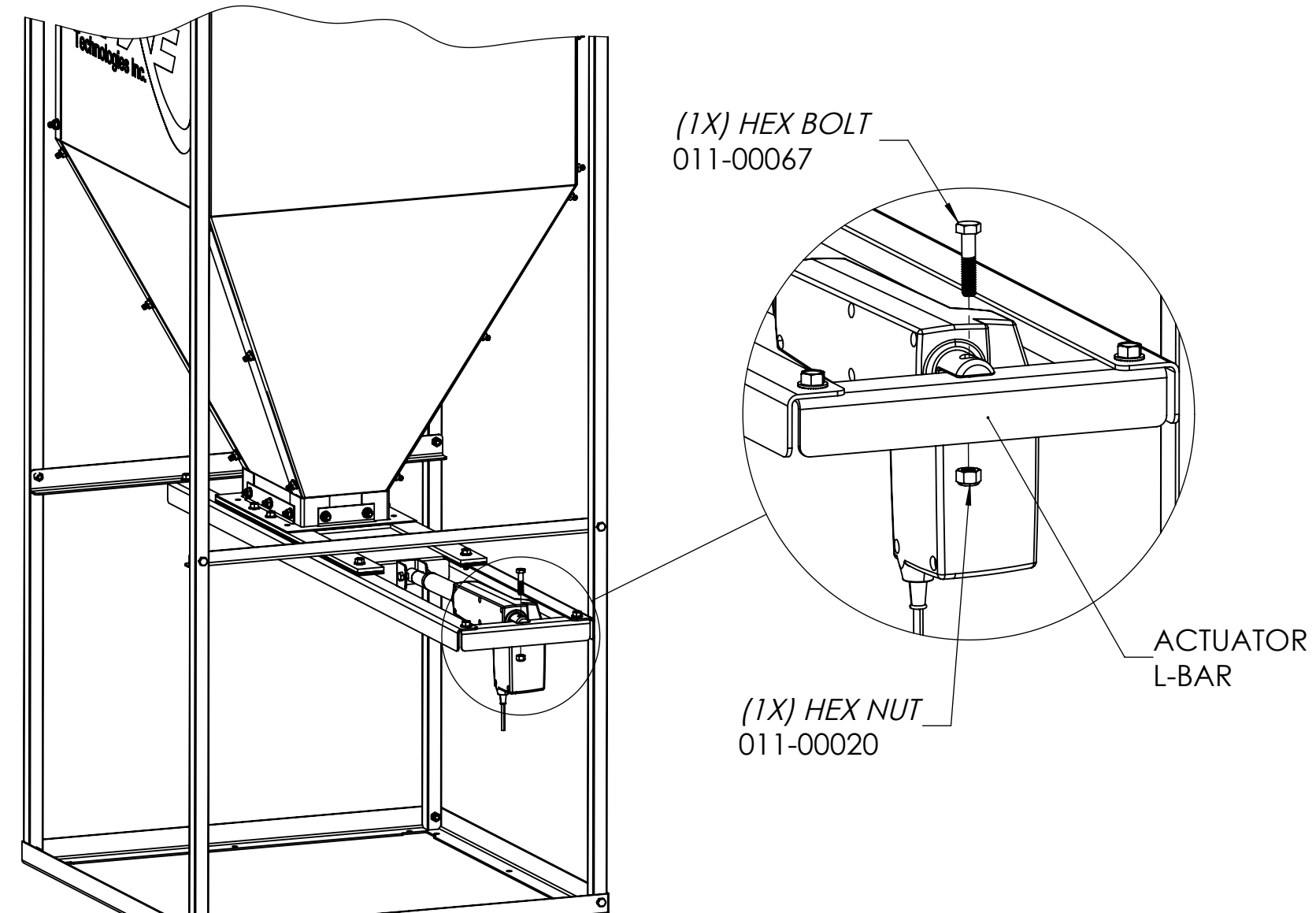

5

6

STEP 27: USE ONE HEX BOLT 011-00067 AND LOCKNUT 011-00020 TO COMPLETE THE INSTALLATION OF THE ACTUATOR BACK FIXTURE ONTO THE ACTUATOR L-BAR.

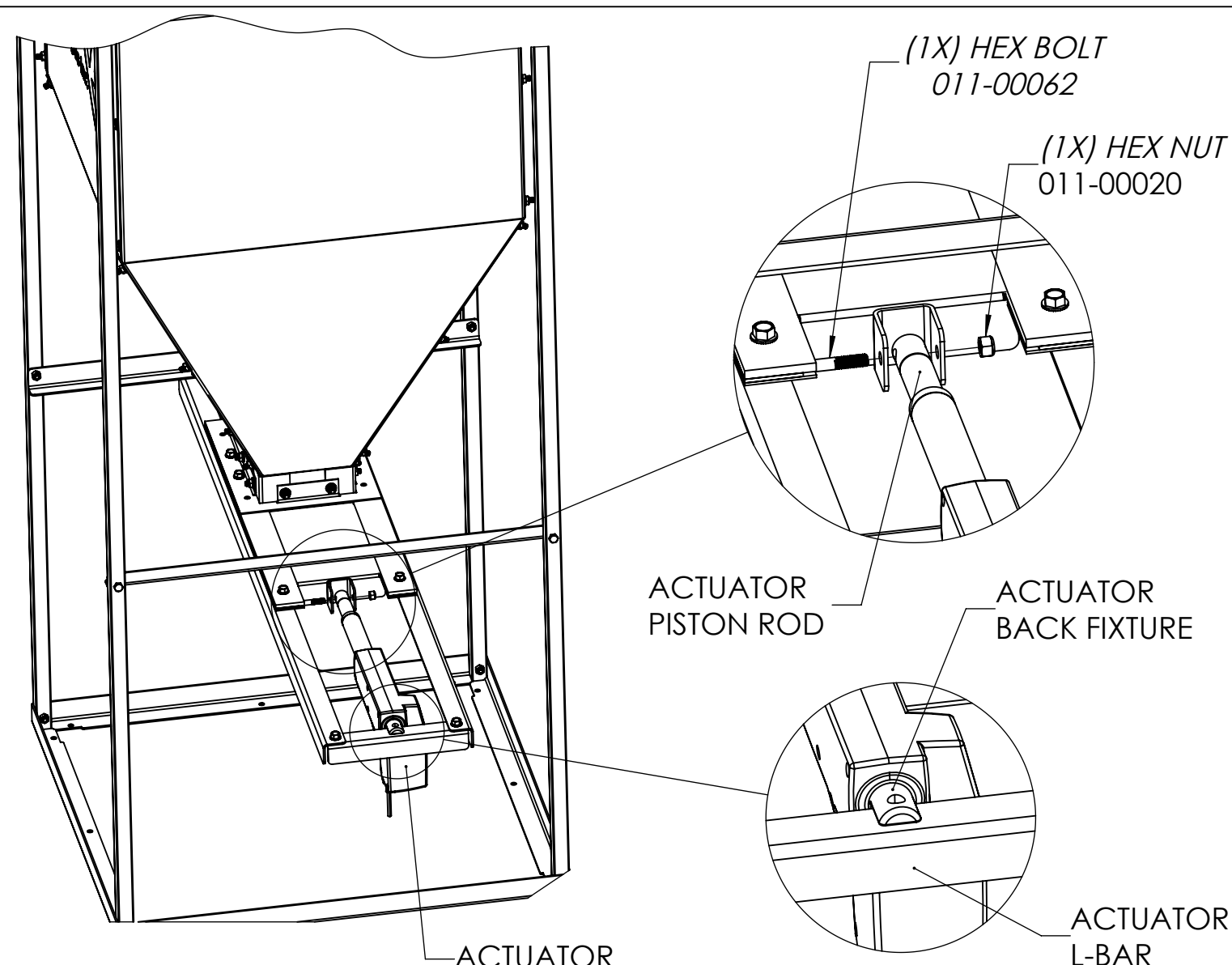

STEP 26: ACTUATOR INSTALLATION : SLIDE THE BACK FIXTURE OPENING ONTO THE ACTUATOR L-BAR AND USE ONE HEX BOLT 011-00062 AND LOCKNUT 011-00020 TO INSTALL THE PISTON ROD END IN THE SLIDE U-BRACKET.

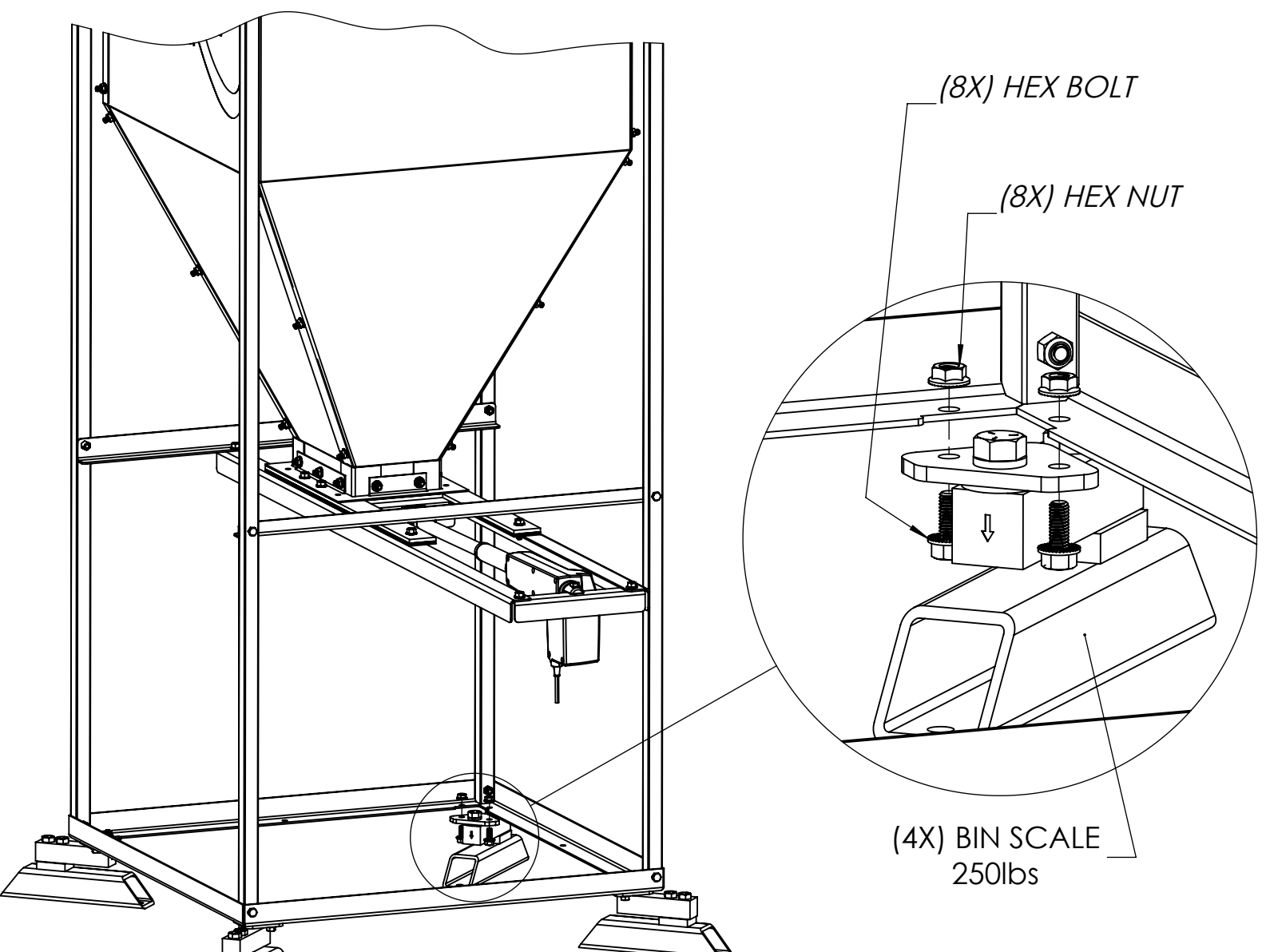

STEP 28: RAISE THE WEIGHING BIN TO THE APPROPRIATE HEIGHT FOR THE BIN SCALES (150 mm [4 1/4 in]) AND INSTALL EACH BIN SCALE USING 2 HEX BOLT 011-00058 AND HEX NUT 011-00059. **REFER TO DRAWING 310-00021 FOR DETAILED INSTRUCTIONS.**



Confidentialité et politiques
Ce document est la propriété ZAXE TECHNOLOGIES et ne peut être utilisé pour d'autres fins que celles pour lesquelles il a été préparé et soumis. Aucune reproduction ne peut être faite sans autorisation.

The information contained in this drawing is the sole property of zaxe technologies. Any reproduction in part or as a whole without the written permission is prohibited.

©2019 Tous les droits réservés /All rights reserved.

No. de produit / Product Part Number:

450-00080

Designation du produit / Product Name

FEED WEIGHER

Titre du dessin / Drawing Title

INSTALLATION GUIDE

Révision / Revision Feuille / Sheet:

A 9 / 10

Matériau / Material specifications:

N/A

Unités / Units:

mm[in]

Standard Tolerances:

Inches

X/X ± 1/16"

X.XX" ±0.03"

X.XXX" ±0.010"

Millimeters

X.X ± 0.8

X.XX ±0.25

Angle

X.X° ± 0.5°

Dernière mise à jour / Last update date:

2021-01-20

Dessiné par / Drawn by:

U

Approuvé par /Approved by:

INSTALLATION PROCEDURE

A

B

C

D

E

F

1

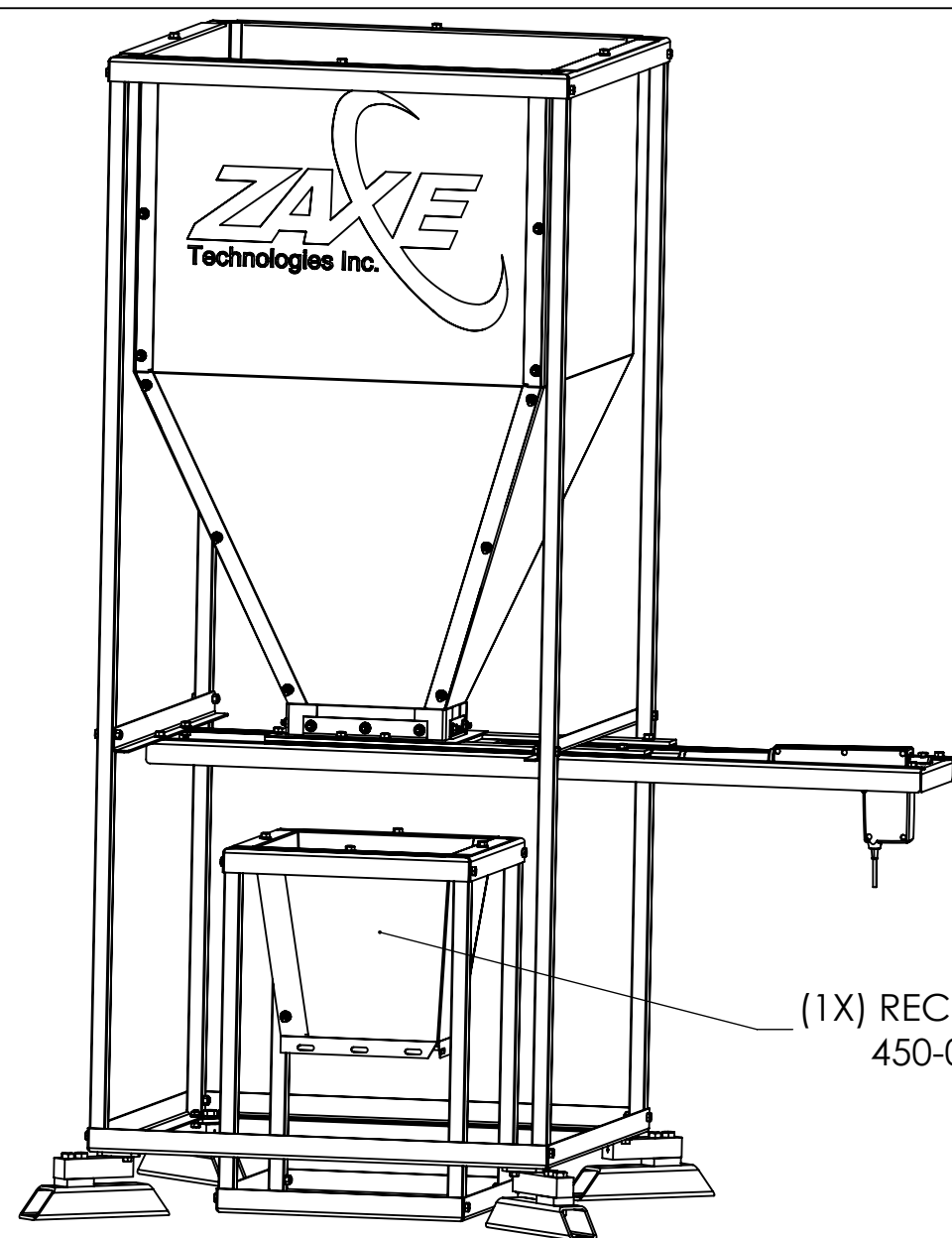

(1X) RECEIVING BIN
450-00080B

STEP 29: INSTALL THE RECEIVING BIN INSIDE THE RECEIVING BIN

(4X) HEX BOLT
011-00060

WEIGHING BIN
EXTENSION

(4X) HEX NUT
011-00059

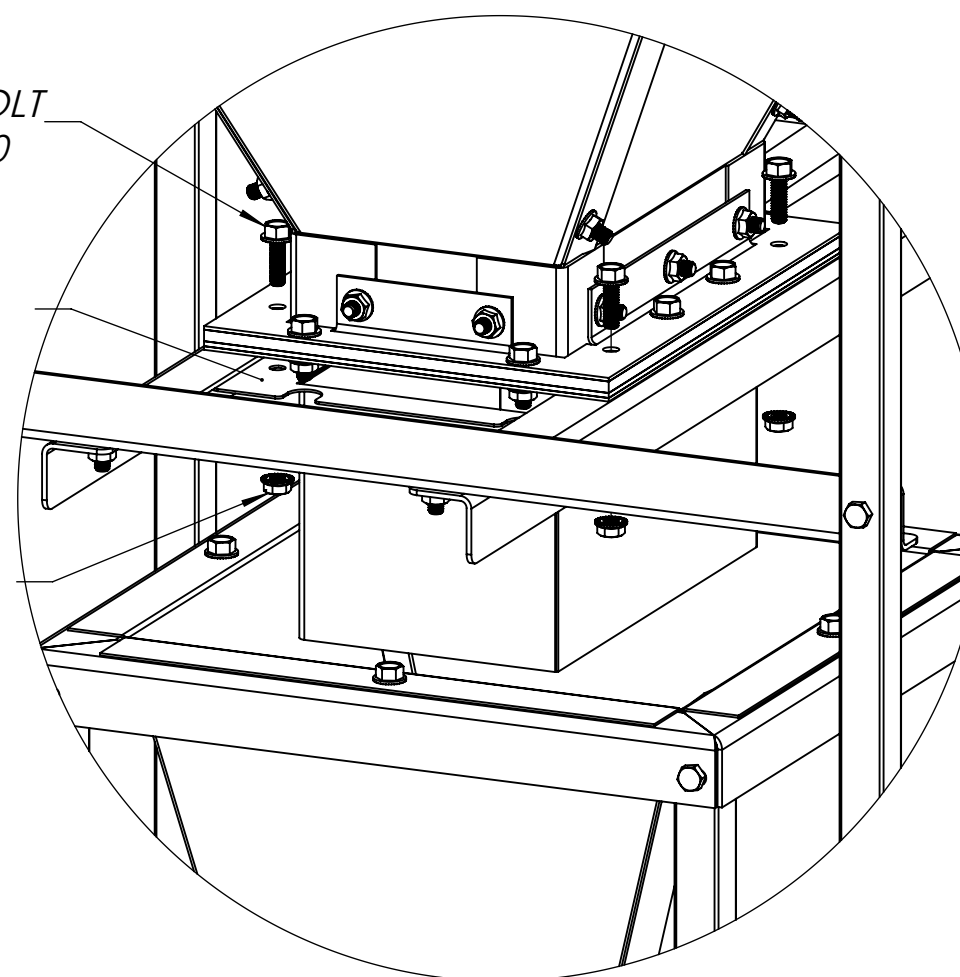

STEP 30: INSTALL THE WEIGHING BIN EXTENSION ONTO THE SLITE GATE ASSEMBLY USING 4 SECURE 4 HEX BOLTS 011-00060 AND HEX NUTS 011-00059. **FULLY TIGHTEN ALL THE BOLTS.**

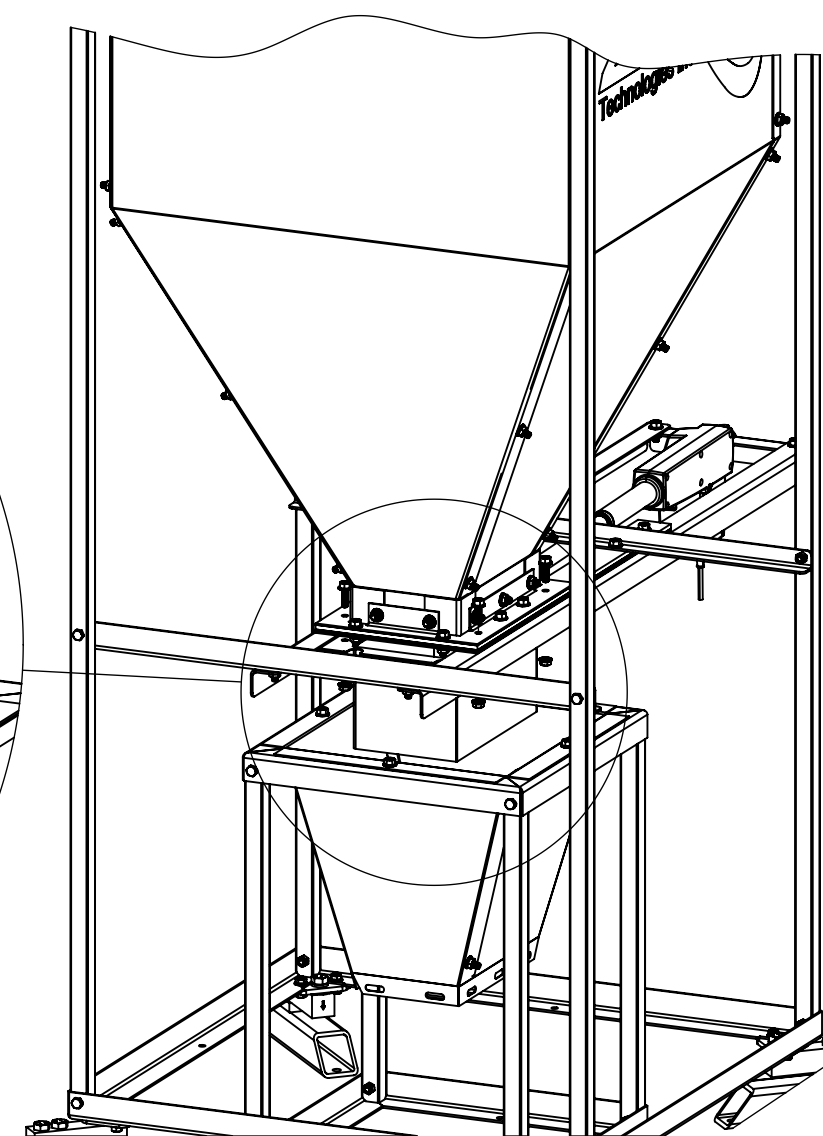

4

(2X) HEX BOLT
011-00058

(2X) WING NUT
011-00110

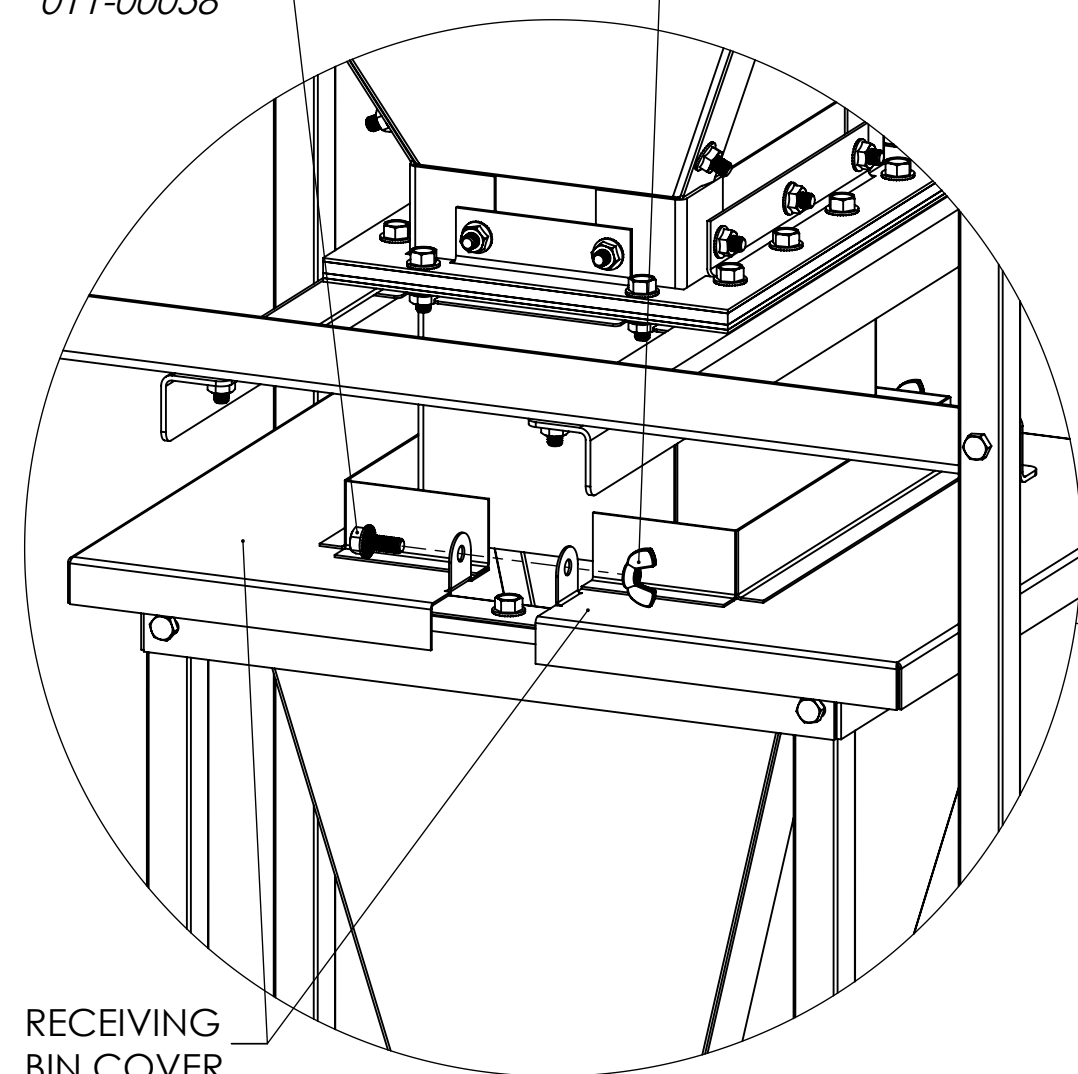

RECEIVING
BIN COVER

6

STEP 31: INSTALL THE TWO HALVES OF THE RECEIVING BIN COVER AND SECURE IT USING 4 HEX BOLTS 011-00058 AND WING NUTS 011-00110.

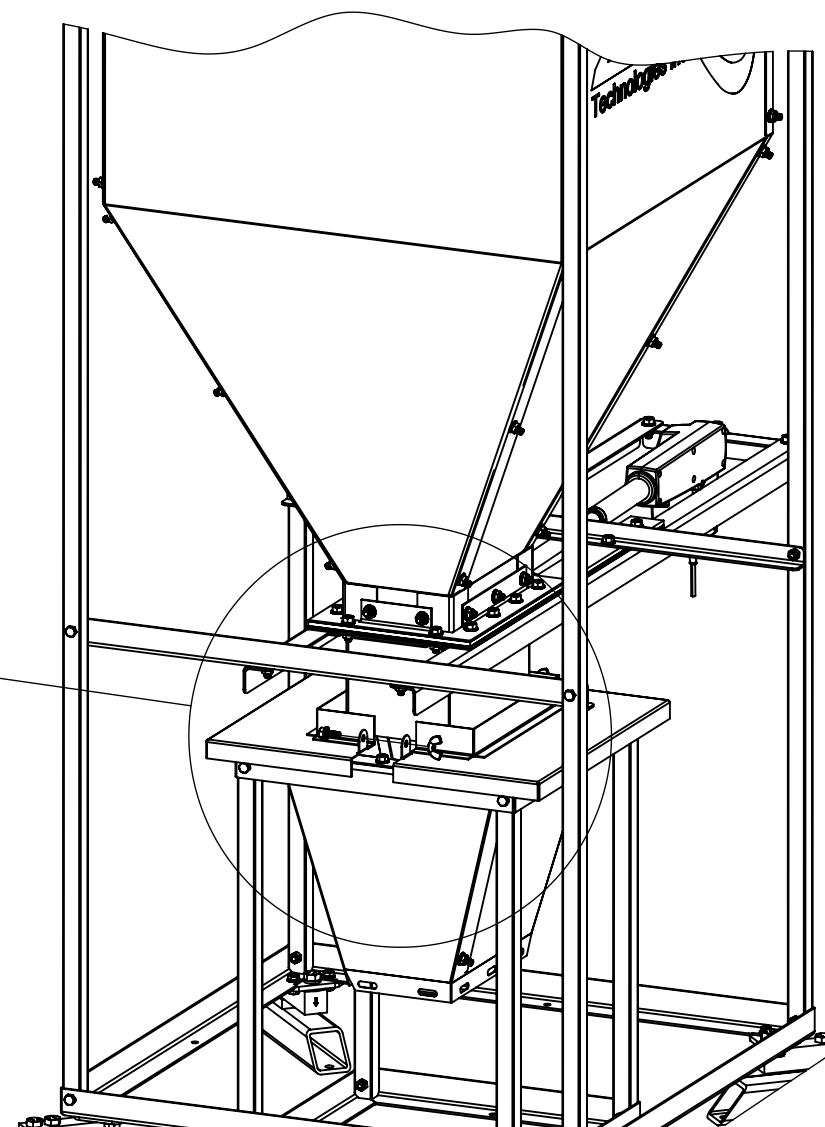



Confidentialité et politiques
 Ce document est la propriété ZAXE TECHNOLOGIES et ne peut être utilisé pour d'autres fins que celles pour lesquelles il a été préparé et soumis. Aucune reproduction ne peut être faite sans autorisation.

The information contained in this drawing is the sole property of zaxe technologies. Any reproduction in part or as a whole without the written permission is prohibited.

©2019 Tous les droits réservés /All rights reserved.

No. de produit / Product Part Number:

450-00080

Designation du produit / Product Name

FEED WEIGHER

Titre du dessin / Drawing Title

INSTALLATION GUIDE

Révision / Revision Feuille / Sheet:

A 10 / 10

Matériau / Material specifications:

N/A

Unités / Units:

mm[in]

Standard Tolerances:

Inches
 X/X ± 1/16"
 X.XX" ±0.03"
 X.XXX" ±0.010"

Millimeters
 X.X ± 0.8
 X.XX ±0.25

Angle
 X.X° ± 0.5°

Dernière mise à jour / Last update date:

2021-01-20

Dessiné par / Drawn by:

U

Approuvé par /Approved by:

INSTALLATION PROCEDURE

1
2
3
4
5
6

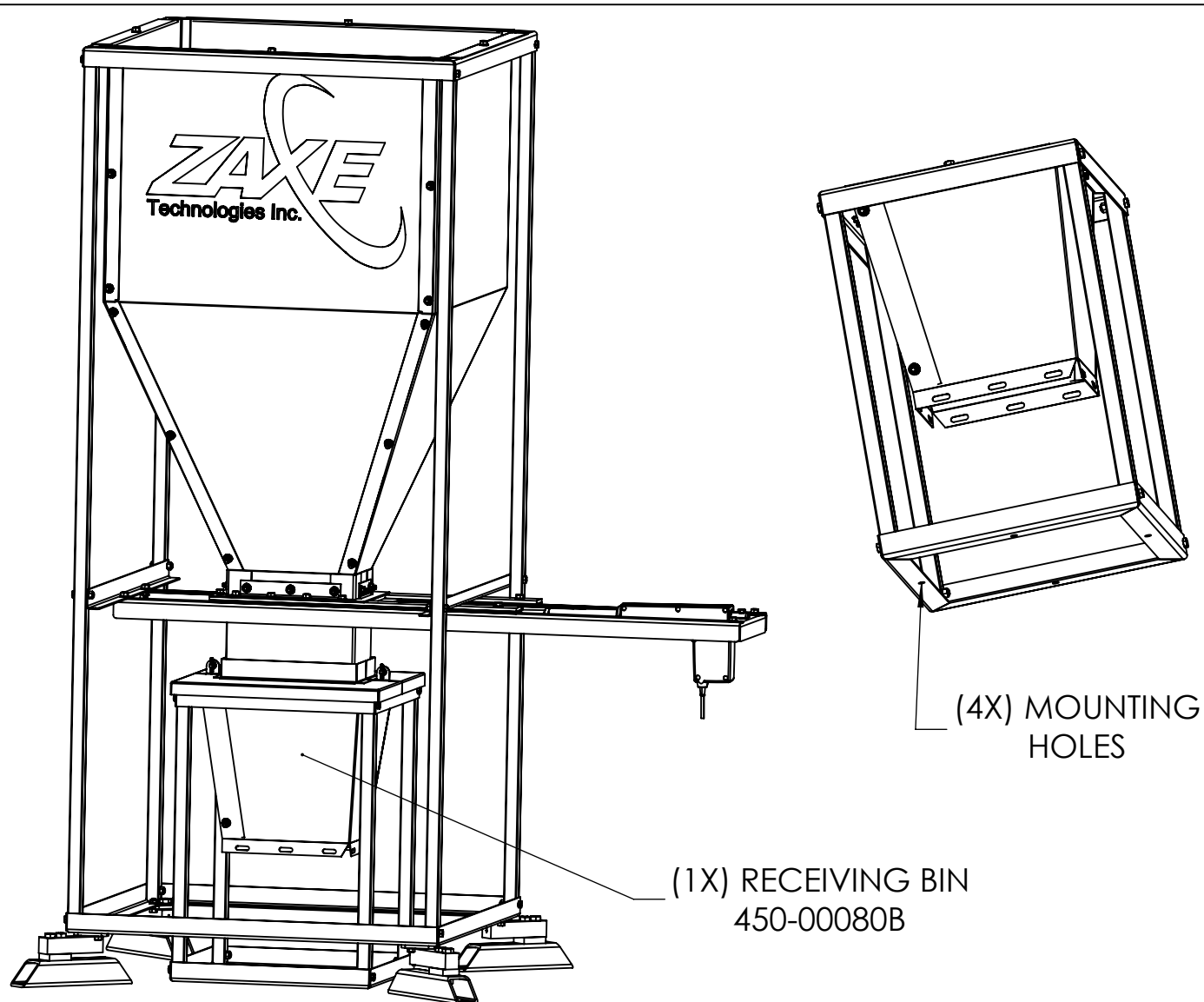

STEP 32: ADJUST IF REQUIRED THE POSITION OF THE RECEIVING BIN SUCH THAT THERE IS AN UNIFORM GAP ALL AROUND BETWEEN THE WEIGHING BIN EXTENSION AND THE RECEIVING COVER AND SECURE IT ON THE SLAB THROUGH THE 4 MOUNTING HOLES ON THE LOWER TOP/BOTTOM FRAME.

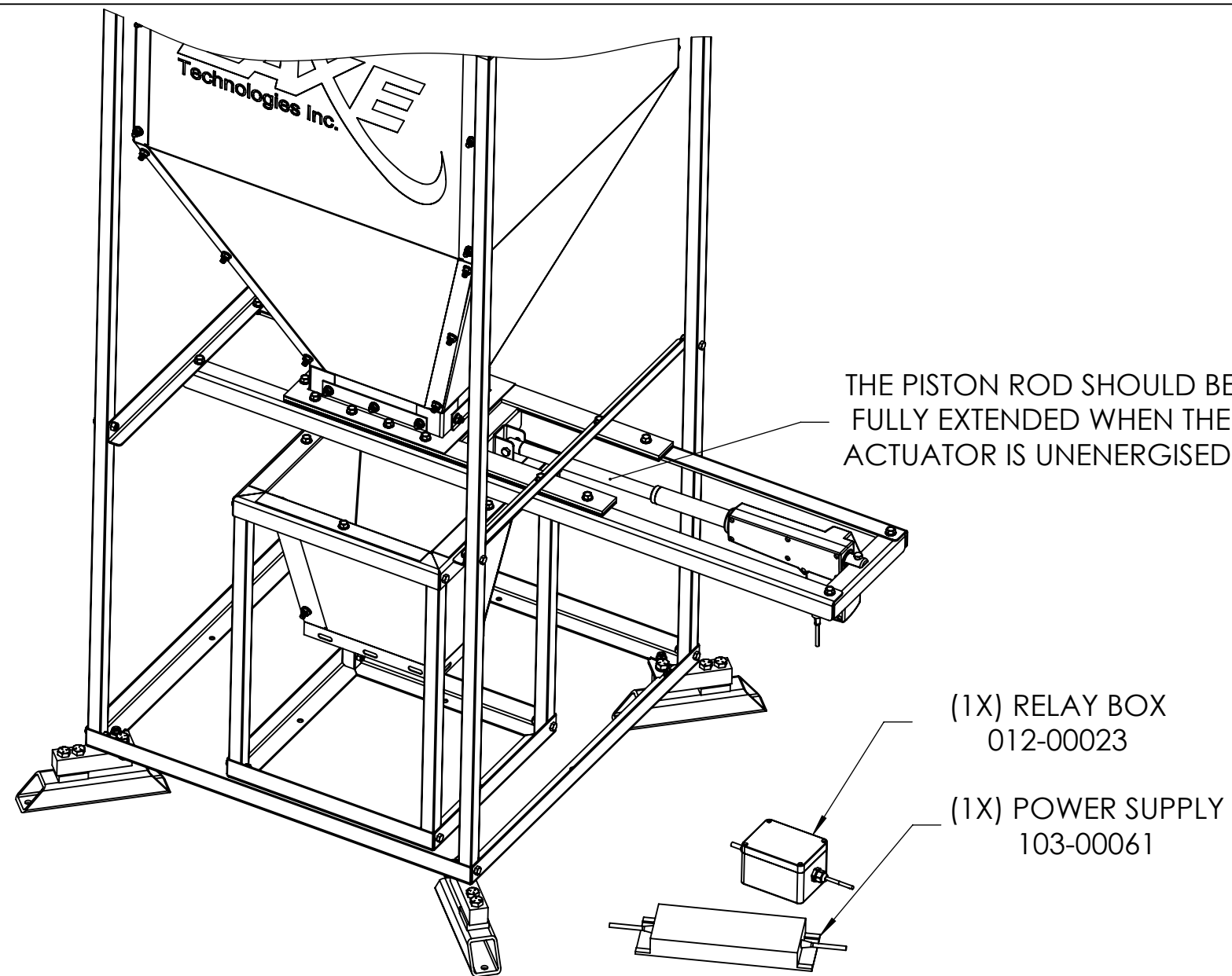

STEP 33: INSTALL THE RELAY BOX AND THE POWER SUPPLY WHERE APPROPRIATE. IF NECESSARY, REFER TO DRAWING **012-00023** FOR THE WIRING DIAGRAM.

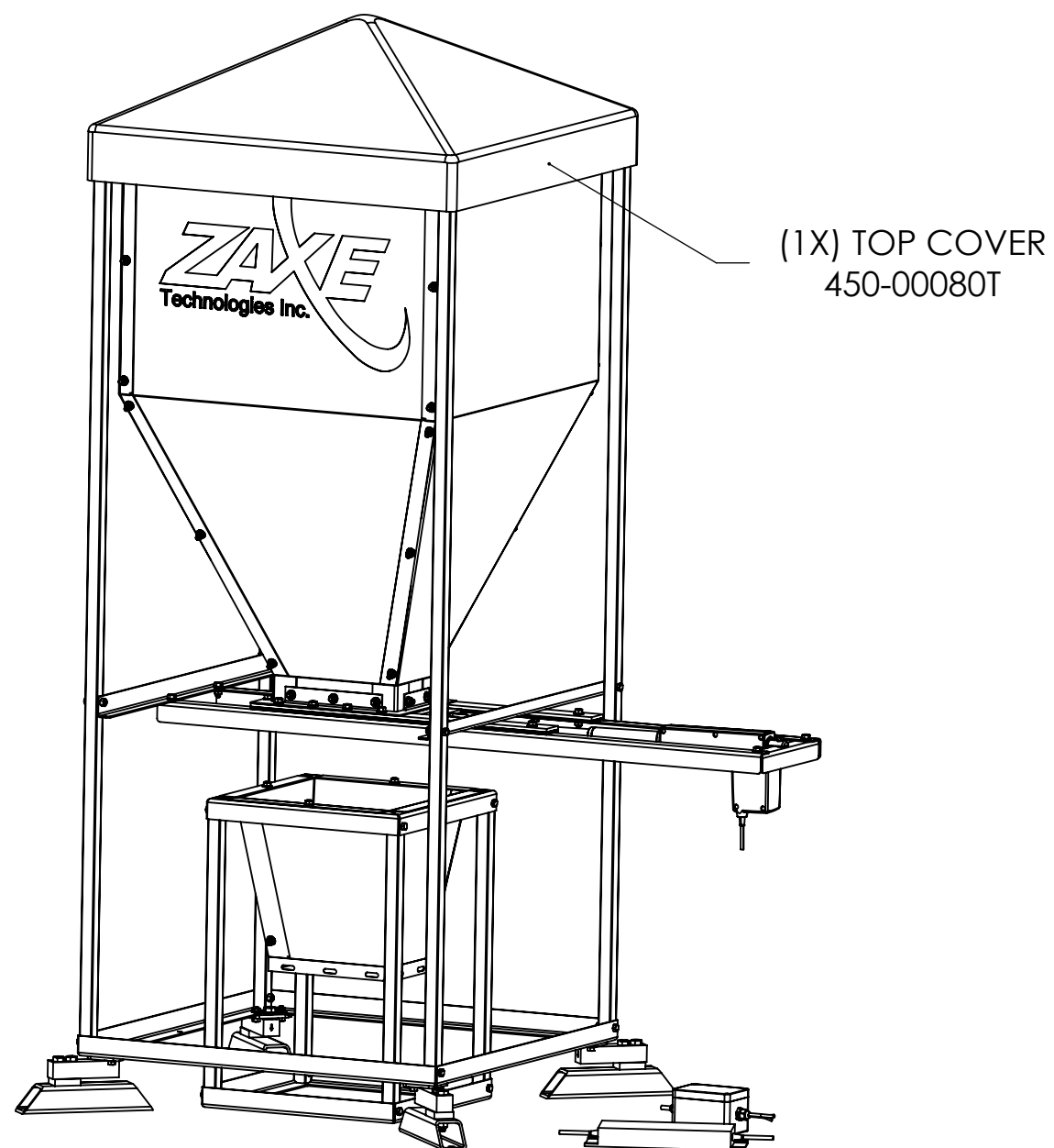

STEP 34: ENSURE ALL THE BOLTS ARE PROPERLY TIGHTEN AND INSTALL THE TOP COVER TO COMPLETE THE INSTALLATION.